

**CITY OF MEADOW LANDFILL  
TERRY COUNTY, TEXAS  
TCEQ PERMIT NO. MSW-2293**

**PERMIT TRANSFER APPLICATION**

Prepared for  
Meadow Landfill, LLC  
April 2022



Prepared by  
**Weaver Consultants Group, LLC**  
TBPE Registration No. F-3727  
6420 Southwest Boulevard, Suite 206  
Fort Worth, Texas 76109  
817-735-9770

WCG Project No. 0120-809-11-01

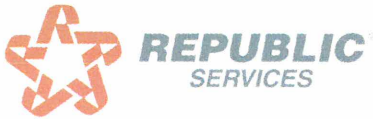

Sustainability in Action

May 2, 2022

Chance Goodin  
MC 124  
Texas Commission on Environmental Quality  
12100 Park 35 Circle, Building F  
Austin, Texas 78753

Re: Permit Transfer Application  
City of Meadow Landfill – TCEQ Permit No. MSW-2293  
Terry County, Texas

Dear Mr. Goodin:

On behalf of the City of Meadow and Meadow Landfill, LLC, please find attached a request to transfer MSW Permit No. 2293 from the City of Meadow to Meadow Landfill, LLC.

This application has been prepared to comply with Title 30 Texas Administrative Code §305.64. Upon transfer of the permit, Meadow Landfill, LLC will assume all operating responsibilities for the facility.

During the course of your review, if you need additional information or have any questions, please call.

Sincerely,  
Meadow Landfill, LLC

A handwritten signature in black ink, appearing to read "Brian Danko", written in a cursive style.

Brian Danko  
Environmental Manager

Attachments: Permit Transfer Application

cc: TCEQ Region 2 Office  
Terri McClanahan, City Administrator, City of Meadow  
Ryne J. Spicer, P.E., Weaver Consultants Group, LLC



## CONTENTS

---

<b>1</b>	<b>INTRODUCTION</b>	<b>1</b>
<b>2</b>	<b>PERMIT TRANSFER</b>	<b>2</b>

### **APPENDIX A**

General Site Location Map

### **APPENDIX B**

Property Owner Affidavit

#### **APPENDIX B-1**

Property Metes and Bounds Description

#### **APPENDIX B-2**

On-Site Easements Statement

### **APPENDIX C**

Currently Approved Closure/Postclosure Costs

#### **APPENDIX C-1**

Proposed 2022 Inflated Closure/Postclosure Costs

### **APPENDIX D**

Legal Authority

### **APPENDIX E**

Evidence of Competency

### **APPENDIX F**

Affected Landowners List and Map

### **APPENDIX G**

TCEQ-10400 Form

### **APPENDIX H**

TCEQ-20650 Form

### **APPENDIX I**

Applicant Certification



## 1 INTRODUCTION

---

The City of Meadow Landfill is a Type IAE solid waste disposal site located at 663 County Road 545, two and one-half miles southeast of the City of Meadow in Terry County. The City of Meadow Landfill began accepting waste in September 2002. The landfill receives up to 40 tons of waste per day or less (20 tons Type I and 20 tons Type IV). The types of waste accepted are municipal solid waste (MSW), demolition/construction, Class II, and Class III industrial waste and special wastes. No Class I industrial waste or hazardous waste is accepted.

The permit is proposed to be transferred from the City of Meadow to Meadow Landfill, LLC. Meadow Landfill, LLC is an indirect, wholly-owned subsidiary of Republic Services, Inc. (Republic). Republic is one of the leading solid waste management companies in the nation. The City of Meadow Landfill property ownership will remain with the City of Meadow. This application has been prepared to comply with Title 30 Texas Administrative Code §305.64

## 2 PERMIT TRANSFER

---

The following information is being provided consistent with 30 TAC §305.64 as an application for a permit transfer.

Transferee: Meadow Landfill, LLC  
1408 N. Martin Luther King Blvd.  
Lubbock, Texas 79403-3022  
325-716-5650 Telephone

Date of Proposed Transfer: May 27, 2022

Financial responsibility will be assumed by Meadow Landfill, LLC, beginning on the date the transfer becomes effective. Meadow Landfill, LLC will provide a Certificate of Assurance in the amount of \$334,862.13 for closure and \$183,827.07 for postclosure care as the financial assurance mechanisms. These costs represent the proposed inflated closure/postclosure costs. A copy of the currently approved and proposed inflated closure and postclosure cost estimate tables are included in Appendix C and Appendix C-1, respectively.

Upon approval of the permit transfer application, the transferee will assume all operating responsibilities for the facility in accordance with the current permit. Effective on the date of the approved transfer, responsibility for compliance with the terms and conditions of the permit and liability for any violation associated therewith is assumed by Meadow Landfill, LLC.

**ACKNOWLEDGEMENT AND CONSENT TO TRANSFER  
OF**

City of Meadow  
and  
Meadow Landfill, LLC

Per 30 TAC § 305.64

To: Texas Commission on Environmental Quality

From: City of Meadow (Transferor)  
Meadow Landfill, LLC (Transferee)

Date: April 29, 2022

City of Meadow, 906 1<sup>st</sup> Street, Meadow, TX 79345

is the current property owner and permit holder under MSW Permit No. 2293.

City of Meadow and Meadow Landfill, LLC

hereby certify that this transfer request is being made with their full knowledge and consent.

Further, City of Meadow and Meadow Landfill, LLC hereby acknowledge and consent to the TCEQ's transfer of the referenced permit from City of Meadow to Meadow Landfill, LLC.

City of Meadow



(Signature)

Terri McClanahan

(Printed Name)

City Administrator

(Title)

Meadow Landfill, LLC



(Signature)

Brian Danko

(Printed Name)

Environmental Manager

(Title)

STATE OF TEXAS §  
§  
COUNTY OF TERRY §

SUBSCRIBED AND SWORN TO before me this 29 day of APRIL, 2022,  
by TERRI McCLANAHAN on behalf of City of Meadow.

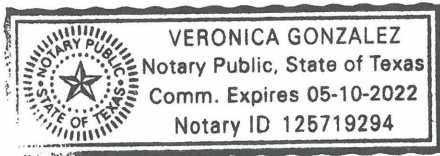

Veronica Gonzalez  
Notary Public, State of Texas

My Commission Expires: 05/10/22

STATE OF TEXAS §  
§  
COUNTY OF TARRANT §

SUBSCRIBED AND SWORN TO before me this 2nd day of May, 2022,  
by Brian Danko on behalf of Meadow Landfill, LLC.

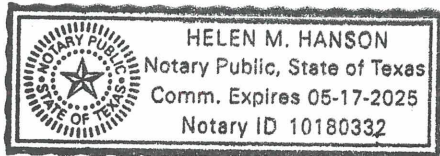

Helen M Hanson  
Notary Public, State of Texas

My Commission Expires: 5/17/2025

**APPENDIX A**  
**GENERAL SITE LOCATION MAP**



**APPENDIX B**  
**PROPERTY OWNER AFFIDAVIT**



**PROPERTY OWNER AFFIDAVIT**

STATE OF TEXAS                   §  
  §  
COUNTY OF TERRY               §

On this day, Terri McClanahan appeared before me, the undersigned notary public, and after I administered an oath to her upon her oath she said:

“My name is Terri McClanahan. I am the City Administrator of the City of Meadow, and I am authorized to make the following statements on behalf of City of Meadow.”

City of Meadow is the owner of certain real property in Terry County, Texas, including the tract(s) described in Appendix B-1 attached hereto ("the Property"), which is included within the permitted area of City of Meadow Landfill municipal solid waste landfill facility ("the Facility"), pursuant to permit transfer of Texas Commission on Environmental Quality Permit No. MSW-2293.

City of Meadow hereby acknowledges that the State of Texas may hold the property owner of record either jointly or severally responsible for the operation, maintenance, and closure and post-closure care of the Facility on the Property.

City of Meadow hereby acknowledges that the owner of the Property has the responsibility to file in the deed records of Terry County an affidavit to the public advising that the Property will be used for a solid waste facility prior to the time that the Facility actually begins operating as a municipal solid waste landfill facility on the Property, and to file a final recording upon completion of disposal operations and closure of the landfill units on the Property in accordance with 30 TAC §330.19.

City of Meadow hereby acknowledges that the Facility owner or operator and the State of Texas shall have access to the Property during the active life and post-closure care of the Facility for the purpose of inspection and maintenance.

Terri McClanahan  
City Administrator  
City of Meadow

SWORN TO AND SUBSCRIBED before me by Terri McClanahan on the 29<sup>th</sup> day of April, 2022.

Notary Public

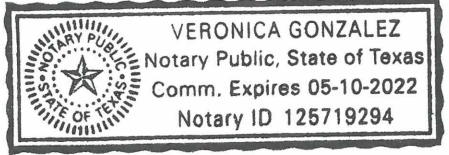

**APPENDIX B-1**  
**PROPERTY METES AND BOUNDS DESCRIPTION**

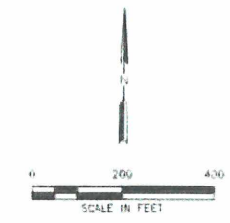
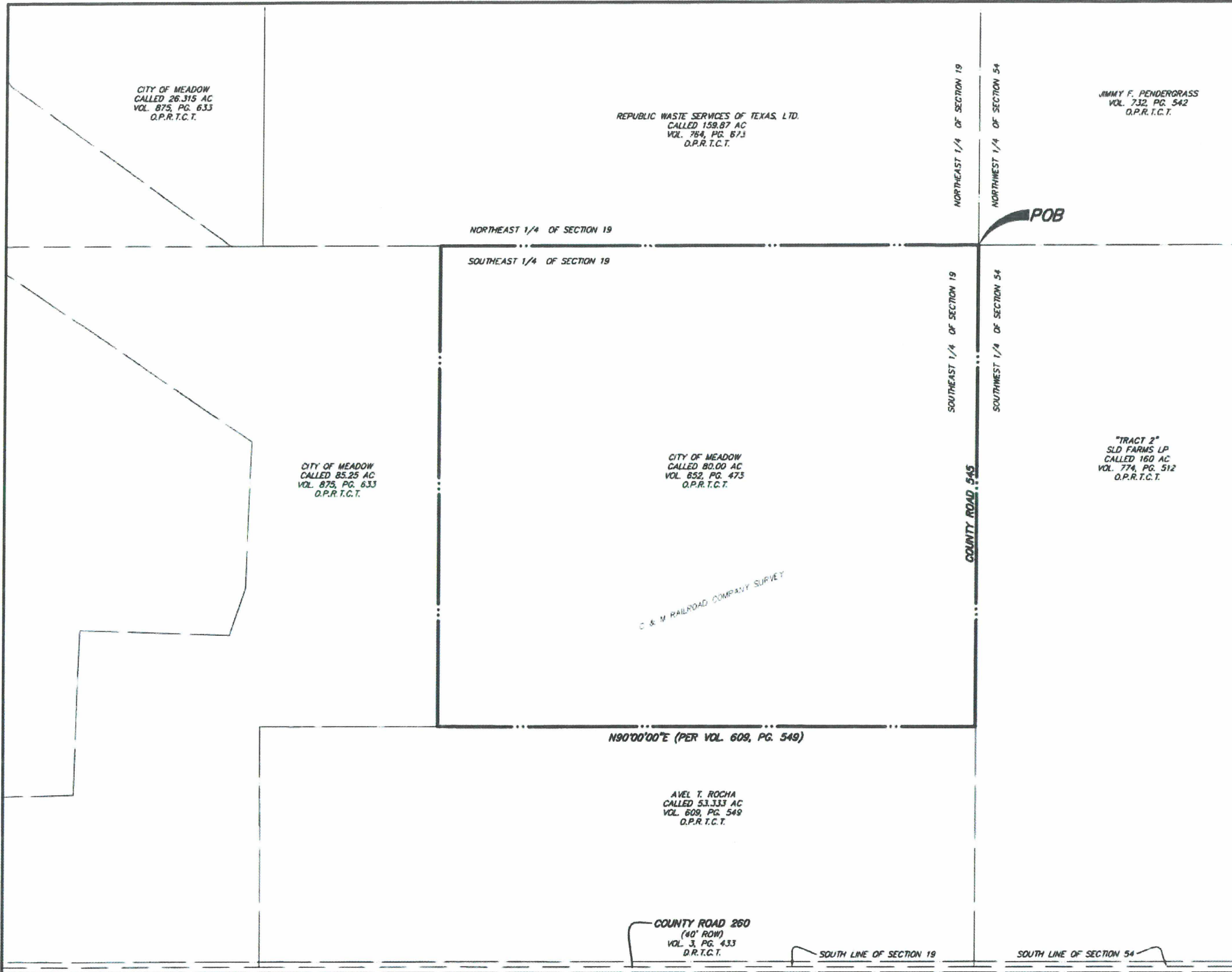

**LEGEND**  
 ———— PROPERTY LINE  
 - - - - - LOT LINE  
 - - - - - SURVEY SECTION LINE

**METES & BOUNDS DESCRIPTION:**

BEING A 3,484,928 SQUARE FOOT (80.00 ACRE) TRACT OF LAND SITUATED IN THE SOUTHEAST QUARTER OF SECTION 19, BLOCK 4X, C & M RAILROAD COMPANY SURVEY, TERRY COUNTY, TEXAS AND BEING ALL OF A CALLED 80.00 ACRE TRACT OF LAND DESCRIBED IN WARRANTY DEED TO CITY OF MEADOW, RECORDED IN VOLUME 652, PAGE 473, OFFICIAL PUBLIC RECORDS, TERRY COUNTY, TEXAS (O.P.R.T.C.T.) AND BEING MORE PARTICULARLY DESCRIBED AS FOLLOWS:

**BEGINNING** AT A POINT FOR THE NORTHEAST CORNER OF SAID 80.00 ACRE TRACT HEREIN DESCRIBED AND FOR THE NORTHEAST CORNER OF SAID SOUTHEAST QUARTER;

**THENCE** SOUTH 00° 02' 03" EAST, ALONG THE EAST LINE OF SAID SOUTHEAST QUARTER, A DISTANCE OF 1,760.20 FEET TO A POINT FOR THE NORTHEAST CORNER OF A CALLED 53.333 ACRE TRACT OF LAND DESCRIBED IN A WARRANTY DEED TO AVEL T. ROCHA, RECORDED IN VOLUME 609, PAGE 549, O.P.R.T.C.T. AND FOR THE SOUTHEAST CORNER OF SAID 80.00 ACRE TRACT;

**THENCE** NORTH 89° 54' 40" WEST, ALONG THE COMMON LINE OF SAID 53.333 ACRE TRACT AND SAID 80.00 ACRE TRACT, A DISTANCE OF 1,981.50 FEET TO A POINT FOR THE SOUTHERLY EAST CORNER OF A CALLED 85.25 ACRE TRACT OF LAND DESCRIBED IN A GENERAL WARRANTY DEED TO CITY OF MEADOW, RECORDED IN VOLUME 875, PAGE 633, O.P.R.T.C.T. AND FOR THE SOUTHWEST CORNER OF SAID 80.00 ACRE TRACT;

**THENCE** NORTH 00° 02' 30" WEST, ALONG THE COMMON LINE OF SAID 85.25 ACRE TRACT AND SAID 80.00 ACRE TRACT, A DISTANCE OF 1,757.20 FEET TO A POINT IN THE NORTH LINE OF SAID SOUTHEAST QUARTER AND FOR THE NORTHERLY EAST CORNER OF SAID 85.25 ACRE TRACT AND FOR THE NORTHWEST CORNER OF SAID 80.00 ACRE TRACT;

**THENCE** SOUTH 89° 59' 52" EAST, ALONG SAID NORTH LINE AND NORTH LINE OF SAID 80.00 ACRE TRACT, A DISTANCE OF 1,981.50 TO THE POINT OF BEGINNING, CONTAINING 3,484,928 SQUARE FEET (80.00 ACRES), MORE OR LESS.

**SURVEYOR CERTIFICATION**

THAT I, ANDREW J. WIDOLFF, A REGISTERED PROFESSIONAL LAND SURVEYOR BY THE STATE OF TEXAS, DO HEREBY AFFIRM THAT THIS EXHIBIT WAS PREPARED UNDER MY DIRECT SUPERVISION.

THIS SEPTEMBER 30, 2021

*Andrew J. Widolff*

ANDREW J. WIDOLFF, RPLS NO. 6771  
 WEAVER CONSULTANTS GROUP, LLC  
 6420 SOUTHWEST BLVD #206  
 FORT WORTH, TX 76109  
 817-735-9770  
 FIRM NO. 10095400

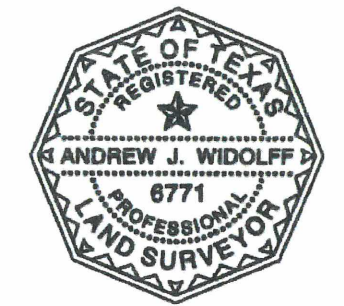

**NOTE:**

1. BASIS OF BEARINGS: THE EAST LINE OF THE SOUTHEAST QUARTER OF SECTION 19, BLOCK 4X, C & M RAILROAD COMPANY SURVEY, AS DESCRIBED IN VOLUME 652, PAGE 473 (SOUTH 00° 02' 30" EAST)
2. PARCEL OWNER INFORMATION SHOWN HEREON, BASED ON AVAILABLE APPRAISAL DISTRICT DATA.
3. THIS EXHIBIT WAS PREPARED FROM TERRY COUNTY DOCUMENTS PROVIDED BY TITLE SEARCH PERFORMED BY LITTLE ARCHER INCORPORATED AND PROVIDED TO THE SURVEYOR ON 9/20/2021. THIS EXHIBIT AND DESCRIPTION ARE NOT BASED ON A FIELD SURVEY AND SHALL NOT BE CONSTRUED AS REPRESENTING A BOUNDARY SURVEY OR RELIED UPON FOR CONVEYANCE OF LAND.
4. NO EASEMENTS OVER THE SUBJECT TRACT WERE DISCLOSED IN DOCUMENTS PROVIDED FROM SAID TITLE SEARCH.

<input type="checkbox"/> DRAFT <input checked="" type="checkbox"/> FOR INFORMATION PURPOSES ONLY <input type="checkbox"/> ISSUED FOR CONSTRUCTION	PREPARED FOR	METES & BOUNDS EXHIBIT
	REPUBLIC SERVICES	
DATE: 09/2021 FILE: 0120-609-11 GNR: 0120-609-11-01 B222 SKETCH/DWG	DRAWN BY: CSS DESIGN BY: AJW REVIEWED BY: AJW	CITY OF MEADOW TYPE IAE LANDFILL TERRY COUNTY, TEXAS
Weaver Consultants Group TBPE REGISTRATION NO. F-3727		
WWW.WCGRP.COM		DRAWING 1

**APPENDIX B-2**  
**ON-SITE EASEMENTS**

## MEMORANDUM

---

**To:** Chance Goodin  
Permit Transfer Application  
Appendix B-2

**Date:** October 11, 2021

**From:** Andrew Widolff, R.P.L.S  
Weaver Consultants Group

**Projects:** 0120-809-11-01

**Re:** Site Easements  
City of Meadow Landfill

---

The purpose of this memorandum is to provide a Surveyor's Statement regarding site easements over the current City of Meadow Landfill: a called 80.00-acre tract described in Warranty Deed to City of Meadow, recorded in Volume 652, Page 473, Official Public Records, Terry County, Texas.

Per title search report and documents provided by Little Archer, Incorporated, no easements of record were found affecting the subject property. No field boundary surveying has been performed by this Surveyor in preparation of this document and no warranty is made against the existence of unrecorded easements.

My hand and seal, October 11, 2021.

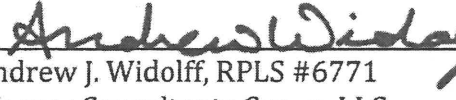
  
Andrew J. Widolff, RPLS #6771  
Weaver Consultants Group, LLC  
6420 Southwest Blvd #206  
Fort Worth, Tx 76109 817-735-9770  
Firm No: 10095400

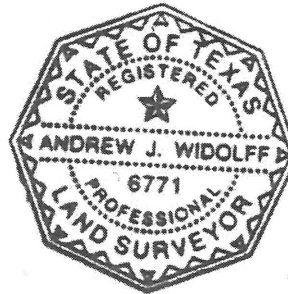

**APPENDIX C**  
**CURRENTLY APPROVED CLOSURE/POSTCLOSURE COSTS**



ATTACHMENT 8  
CLOSURE COSTS

QUANTITIES				
Number of pits	4			
Size of Pits	Length(ft)	Width(ft)	Depth(ft)	Volume(cy)
Type I (2)	760	60	20	67,556
Type IV (2)	630	60	20	56,000
<b>Total</b>				<b>123,556</b>
Total Volume Fill (cy)				111,200
Total Cover Volume (cy)				12,356
Seeding (1000 sf)				167

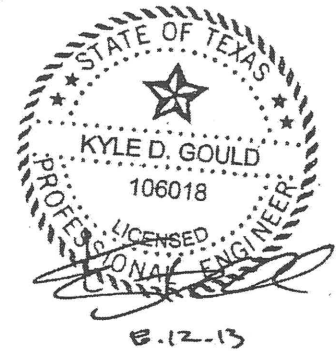

	Unit	2001		2013		2013	
		Unit Price	Inflation Factor <sup>1</sup>	Unit Price	Quantity	Extension	
Fill	cy	\$ 1.50	1.284	\$ 1.93	111,200	\$ 214,171	
Bentonite	ton	\$ 115.00	1.284	\$ 147.66	90	\$ 13,289	
Cover Processing/Final Grading	cy	\$ 2.00	1.284	\$ 2.57	12,356	\$ 31,729	
Seeding	1000 sf	\$ 25.00	1.284	\$ 32.10	167	\$ 5,354	
Engineering	ls	\$ 3,000.00	1.284	\$ 3,852.00	1	\$ 3,852	
Topographic/Boundary Survey	ls	\$ 2,000.00	1.284	\$ 2,568.00	1	\$ 2,568	
Testing (Final Cover)	ls	\$ 3,000.00	1.284	\$ 3,852.00	1	\$ 3,852	
Administration	ls	\$ 2,000.00	1.284	\$ 2,568.00	1	\$ 2,568	
Contingency	ls	\$ 5,000.00	1.284	\$ 6,420.00	1	\$ 6,420	
<b>Total Closure Costs</b>						<b>\$ 283,804</b>	

<sup>1</sup> Inflation factor is a product of the annual percentage change for each year between 2001 and 2013 as published by the TCEQ (2.4, 1.7, 2.0, 2.6, 2.8, 2.9, 2.7, 2.2, 1.2, 0.9, 2.1, and 1.8 for 2001, 2002, 2003, 2004, 2005, 2006, 2007, 2008, 2009, 2010, 2011, and 2012, respectively).

ATTACHMENT 8  
POST-CLOSURE COSTS

POST CLOSURE COSTS						
		<u>2001</u>	<u>Inflation</u>	<u>2013</u>		<u>2013</u>
	<u>Unit</u>	<u>Unit Price</u>	<u>Factor<sup>1</sup></u>	<u>Unit Price</u>	<u>Quantity</u>	<u>Extension</u>
Maintain & Repair Fencing		\$ 100.00	1.284	\$ 128.40	1	\$ 128
<b>Final Cover Maintenance for Total Area of Permitted Landfill:</b>						
Mowing	ls	\$ 500.00	1.284	\$ 642.00	1	\$ 642
Grading	ls	\$ 500.00	1.284	\$ 642.00	1	\$ 642
Reseeding	ls	\$ 200.00	1.284	\$ 256.80	1	\$ 257
Gas Vent Maintenance	ls	\$ 200.00	1.284	\$ 256.80	1	\$ 257
Gas Monitoring (Quarterly)	ls/qtr	\$ 150.00	1.284	\$ 192.60	4	\$ 770
Inspection & Records	ls	\$ 200.00	1.284	\$ 256.80	1	\$ 257
Administration	ls	\$ 250.00	1.284	\$ 321.00	1	\$ 321
Contingency	ls	\$ 600.00	1.284	\$ 770.40	1	\$ 770
<b>Total Post Closure Costs/Year</b>						<b>\$ 4,045</b>
<b>Total Post Closure Care Costs</b>	<b>\$/yr</b>	<b>\$ 4,045</b>			<b>30</b>	<b>\$ 121,338</b>

<sup>1</sup> Inflation factor is a product of the annual percentage change for each year between 2001 and 2013 as published by the TCEQ (2.4, 1.7, 2.0, 2.6, 2.8, 2.9, 2.7, 2.2, 1.2, 0.9, 2.1, and 1.8 for 2001, 2002, 2003, 2004, 2005, 2006, 2007, 2008, 2009, 2010, 2011, and 2012, respectively).



8.12.13



**APPENDIX C-1**  
**PROPOSED INFLATED CLOSURE/POSTCLOSURE COSTS**

**QUANTITIES**

<b>Number of pits</b>	4			
<b>Size of Pits</b>	<u>Length(ft)</u>	<u>Width(ft)</u>	<u>Depth(ft)</u>	<u>Volume(cy)</u>
Type I (2)	760	60	20	<b>67,556</b>
Type IV (2)	630	60	20	<b>56,000</b>
<b>Total</b>				<b>123,556</b>

<b>Total Volume Fill (cy)</b>	<b>111,200</b>
<b>Total Cover Volume (cy)</b>	<b>12,356</b>
<b>Seeding (1000 sf)</b>	<b>167</b>

**CLOSURE COSTS**

	<u>Unit</u>	<u>2001 Unit Price</u>	<u>Inflation Factor<sup>1</sup></u>	<u>2013 Unit Price</u>	<u>Proposed Unit Price</u>	<u>Quantity</u>	<u>2013 Extension</u>	<u>Proposed Extension</u>
<b>Fill</b>	cy	\$ 1.50	<del>1.284</del> 1.515	<del>\$ 1.93</del>	\$ 2.27	111,200	<del>\$ 214,171</del>	\$ 252,702.00
<b>Bentonite</b>	ton	\$ 115.00	<del>1.284</del> 1.515	<del>\$ 147.66</del>	\$ 174.23	90	<del>\$ 13,289</del>	\$ 15,680.25
<b>Cover Processing/Final Grading</b>	cy	\$ 2.00	<del>1.284</del> 1.515	<del>\$ 2.57</del>	\$ 3.03	12,356	<del>\$ 31,729</del>	\$ 37,437.33
<b>Seeding</b>	1000 sf	\$ 25.00	<del>1.284</del> 1.515	<del>\$ 32.10</del>	\$ 37.88	167	<del>\$ 5,354</del>	\$ 6,317.55
<b>Engineering</b>	ls	\$ 3,000.00	<del>1.284</del> 1.515	<del>\$ 3,852.00</del>	\$ 4,545.00	1	<del>\$ 3,852</del>	\$ 4,545.00
<b>Topographic/Boundary Survey</b>	ls	\$ 2,000.00	<del>1.284</del> 1.515	<del>\$ 2,568.00</del>	\$ 3,030.00	1	<del>\$ 2,568</del>	\$ 3,030.00
<b>Testing (Final Cover)</b>	ls	\$ 3,000.00	<del>1.284</del> 1.515	<del>\$ 3,852.00</del>	\$ 4,545.00	1	<del>\$ 3,852</del>	\$ 4,545.00
<b>Administration</b>	ls	\$ 2,000.00	<del>1.284</del> 1.515	<del>\$ 2,568.00</del>	\$ 3,030.00	1	<del>\$ 2,568</del>	\$ 3,030.00
<b>Contingency</b>	ls	\$ 5,000.00	<del>1.284</del> 1.515	<del>\$ 6,420.00</del>	\$ 7,575.00	1	<del>\$ 6,420</del>	\$ 7,575.00
<b>Total Closure Costs</b>							<del>\$ 283,804</del>	\$ 334,862.13

<sup>1</sup> Inflation factor is a product of the annual percentage change for each year between 2001 and 2022 as published by the TCEQ (2.4, 1.7, 2.0, 2.6, 2.8, 2.9, 2.7, 2.2, 1.2, 0.9, 2.1, 1.8, 1.5, 1.5, 1, 1.3, 1.8, 2.3, 1.8, 1.2 and 4.2 for 2001, 2002, 2003, 2004, 2005, 2006, 2007, 2008, 2009, 2010, 2011, 2012, 2013, 2014, 2015, 2016, 2017, 2018, 2019, 2020 and 2021 respectively).



ATTACHMENT 8  
POST-CLOSURE COSTS

POST CLOSURE COSTS

	2001		Inflation Factor <sup>1</sup>	2013		Proposed Unit Price	Quantity	2013		Proposed Extension
	Unit	Unit Price		Unit Price	Extension					
<b>Maintain &amp; Repair Fencing</b>		\$ 100.00	1.284	1.515	\$ 128.40	\$ 194.53	1	\$ 128	\$ 194.53	
<b>Final Cover Maintenance for Total Area of Permitted Landfill:</b>										
Mowing	ls	\$ 500.00	1.284	1.515	\$ 642.00	\$ 972.63	1	\$ 642	\$ 972.63	
Grading	ls	\$ 500.00	1.284	1.515	\$ 642.00	\$ 972.63	1	\$ 642	\$ 972.63	
Reseeding	ls	\$ 200.00	1.284	1.515	\$ 256.80	\$ 389.05	1	\$ 257	\$ 389.05	
Gas Vent Maintenance	ls	\$ 200.00	1.284	1.515	\$ 256.80	\$ 389.05	1	\$ 257	\$ 389.05	
Gas Monitoring (Quarterly)	ls/qtr	\$ 150.00	1.284	1.515	\$ 192.60	\$ 291.79	4	\$ 770	\$ 1,167.16	
Inspection & Records	ls	\$ 200.00	1.284	1.515	\$ 256.80	\$ 389.05	1	\$ 257	\$ 389.05	
Administration	ls	\$ 250.00	1.284	1.515	\$ 321.00	\$ 486.32	1	\$ 321	\$ 486.32	
Contingency	ls	\$ 600.00	1.284	1.515	\$ 770.40	\$ 1,167.16	1	\$ 770	\$ 1,167.16	
<b>Total Post Closure Costs/Year</b>								\$ 4,045	\$ 6,128	
<b>Total Post Closure Care Costs</b>	\$/yr	\$ 4,045					30	\$ 121,338	\$ 183,827.07	
		\$ 6,128								

<sup>1</sup> Inflation factor is a product of the annual percentage change for each year between 2001 and 2022 as published by the TCEQ (2.4, 1.7, 2.0, 2.6, 2.8, 2.9, 2.7, 2.2, 1.2, 0.9, 2.1, 1.8, 1.5, 1.5, 1, 1.3, 1.8, 2.3, 1.8, 1.2 and 4.2 for 2001, 2002, 2003, 2004, 2005, 2006, 2007, 2008, 2009, 2010, 2011, 2012, 2013, 2014, 2015, 2016, 2017, 2018, 2019, 2020 and 2021 respectively).



**APPENDIX D**  
**LEGAL AUTHORITY**



## Office of the Secretary of State

The undersigned, as Secretary of State of Texas, does hereby certify that the attached is a true and correct copy of each document on file in this office as described below:

Meadow Landfill, LLC  
Filing Number: 804386533

Application for Registration

January 05, 2022

In testimony whereof, I have hereunto signed my name officially and caused to be impressed hereon the Seal of State at my office in Austin, Texas on April 13, 2022.



A handwritten signature in black ink, appearing to read "John B. Scott".

John B. Scott  
Secretary of State

**Form 304**  
**(Revised 05/11)**

Submit in duplicate to:  
Secretary of State  
P.O. Box 13697  
Austin, TX 78711-3697  
512 463-5555  
FAX: 512/463-5709  
Filing Fee: \$750



**Application for  
Registration  
of a Foreign Limited  
Liability Company**

This space reserved for office use.

**FILED**  
**In the Office of the  
Secretary of State of Texas**

**JAN 05 2022**

**Corporations Section**

1. The entity is a foreign limited liability company. The name of the entity is:

Meadow Landfill, LLC

*Provide the full legal name of the entity as stated in the entity's formation document in its jurisdiction of formation.*

2A. The name of the entity in its jurisdiction of formation does not contain the word "limited liability company" or "limited company" (or an abbreviation thereof). The name of the entity with the word or abbreviation that it elects to add for use in Texas is:

2B. The entity name is not available in Texas. The assumed name under which the entity will qualify and transact business in Texas is:

*The assumed name must include an acceptable organizational identifier or an accepted abbreviation of one of these terms.*

3. Its federal employer identification number is: 86-1036041

Federal employer identification number information is not available at this time.

4. It is organized under the laws of: (set forth state or foreign country) Delaware

and the date of its formation in that jurisdiction is: 07/11/2001

*mm/dd/yyyy*

5. As of the date of filing, the undersigned certifies that the foreign limited liability company currently exists as a valid limited liability company under the laws of the jurisdiction of its formation.

6. The purpose or purposes of the limited liability company that it proposes to pursue in the transaction of business in Texas are set forth below.

non-hazardous solid waste management

The entity also certifies that it is authorized to pursue such stated purpose or purposes in the state or country under which it is organized.

7. The date on which the foreign entity intends to transact business in Texas, or the date on which the foreign entity first transacted business in Texas is: upon qualification

*mm/dd/yyyy*

*Late fees may apply (see instructions).*

8. The principal office address of the limited liability company is:

18500 North Allied Way

Phoenix

AZ

USA

85054

*Address*

*City*

*State*

*Country*

*Zip/Postal Code*

**RECEIVED**

**JAN 05 2022**

**Secretary of State**

Complete item 9A or 9B, but not both. Complete item 9C.

9A. The registered agent is an organization (cannot be entity named above) by the name of:

C T Corporation System

OR

9B. The registered agent is an individual resident of the state whose name is:

First Name M.I. Last Name Suffix

9C. The business address of the registered agent and the registered office address is:

1999 Bryan St. Suite 900 Dallas TX 75201-3136  
Street Address City State Zip Code

10. The entity hereby appoints the Secretary of State of Texas as its agent for service of process under the circumstances set forth in section 5.251 of the Texas Business Organizations Code.

11. The name and address of each governing person is:

<b>NAME AND ADDRESS OF GOVERNING PERSON:</b> (Enter the name of either an individual or an organization, but not both.)				
IF INDIVIDUAL				
First Name	M.I.	Last Name	Suffix	
OR				
IF ORGANIZATION				
Republic Waste Services of Texas, Ltd.				
Organization Name				
18500 North Allied Way	Phoenix	AZ	USA	85054
Street or Mailing Address	City	State	Country	Zip Code

<b>NAME AND ADDRESS OF GOVERNING PERSON:</b> (Enter the name of either an individual or an organization, but not both.)				
IF INDIVIDUAL				
First Name	M.I.	Last Name	Suffix	
OR				
IF ORGANIZATION				
Organization Name				
Street or Mailing Address	City	State	Country	Zip Code

<b>NAME AND ADDRESS OF GOVERNING PERSON:</b> (Enter the name of either an individual or an organization, but not both.)				
IF INDIVIDUAL				
First Name	M.I.	Last Name	Suffix	
OR				
IF ORGANIZATION				
Organization Name				
Street or Mailing Address	City	State	Country	Zip Code

**Supplemental Provisions/Information**

Text Area: [The attached addendum, if any, is incorporated herein by reference.]

**Effectiveness of Filing:** (Select either A, B, or C.)

- A.  This document becomes effective when the document is filed by the secretary of state.
- B.  This document becomes effective at a later date, which is not more than ninety (90) days from the date of signing. The delayed effective date is: \_\_\_\_\_
- C.  This document takes effect upon the occurrence of a future event or fact, other than the passage of time. The 90<sup>th</sup> day after the date of signing is: \_\_\_\_\_

The following event or fact will cause the document to take effect in the manner described below:

**Execution**

The undersigned affirms that the person designated as registered agent has consented to the appointment. The undersigned signs this document subject to the penalties imposed by law for the submission of a materially false or fraudulent instrument and certifies under penalty of perjury that the undersigned is authorized under the provisions of law governing the entity to execute the filing instrument.

Date: January 5, 2022

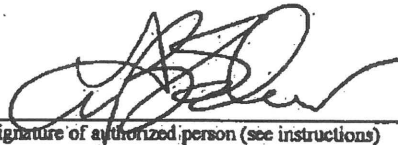

Signature of authorized person (see instructions)

Eileen B. Schuler

Printed or typed name of authorized person.



**APPENDIX E**  
**EVIDENCE OF COMPETENCY**

## EVIDENCE OF COMPETENCY

---

### **Republic Solid Waste Sites**

The applicant, Meadow Landfill, LLC, is an indirect, wholly-owned subsidiary of Republic Services, Inc. (Republic). Republic or its subsidiaries own, operate, or maintain a financial interest in the facilities identified in Tables E-1 and E-2. A listing of the state regulatory agencies for these facilities is provided in Table E-3. Republic acquires, operates, and develops nonhazardous waste disposal facilities on a national basis and is one of the largest providers of municipal waste services in the United States. Republic is a Delaware corporation whose shares are publicly traded on the New York stock exchange. As documented in Republic's 2021 Annual Report, no person or entity owns 20 percent or more of the company.

### **Meadow Landfill, LLC Key Personnel**

#### **Yasser Brenes, Area President**

Mr. Brenes is responsible for all hauling, transfer stations, and landfill operations in the Texas area. Responsibilities include financial planning and environmental compliance, as well as other management responsibilities. Also, he oversees operations; sales and marketing; and finance for Republic's landfills, transfer stations, recycling, and waste collection operations.

#### **Scott A. Trebus, Area Environmental Manager**

Mr. Trebus is responsible for the engineering management, regulatory coordination, and environmental compliance of Republic's facilities within the South Area.

#### **Brian Danko, Environmental Manager**

Mr. Danko has management and oversight responsibilities for environmental compliance at Republic's landfills, transfer stations, and hauling facilities in the West Texas area. Mr. Danko, upon approval of the permit transfer, will have primary responsibility for permitting and environmental compliance at the City of Meadow Landfill.

#### **Operations Manager**

This position will be responsible for the daily operations of the City of Meadow Landfill. His or her responsibilities include oversight of hourly employees,

equipment maintenance, construction management, and operations compliance. This position will hold a Texas Class A license for MSW Landfill Management and Operations.

## **Equipment**

The equipment listed in Part IV – Site Operating Plan, Table 3.1 is used to operate this site. Additional or different units of equipment may be provided as necessary to enhance operational efficiency. Other equivalent types of equipment may be substituted for this equipment on an as-needed basis.

**Table E-1  
Texas Solid Waste Facilities  
Republic Services  
(as of April 2022)**

Name & Location	Permit Type & No.	Dates of Operation <sup>1</sup>
<b>NORTH TEXAS AREA</b>		
Southwest Landfill Randall County	Type 1, MSW No. 1663C	1985 to present
Abilene Regional Landfill Jones County	Type 1, MSW No. 1469A	1983 to present
Brazos Transfer Station Parker County	Type 5TS, MSW No. 2356	April 7, 2008, to present
Camelot Landfill Denton County	Type 1, MSW No. 1312B	Dec. 1979 to present
Charter Waste Landfill Ector County	Type 1, MSW No. 2158A	May 26, 1992, to present
City of Arlington Landfill Tarrant County	Type 1, MSW No. 358A	March 14, 1978, to present
City of Fort Worth Southeast Landfill Tarrant County	Type 1, MSW No. 218C	1976 to present
CSC Landfill Ellis County	Type 1, MSW No. 1209B	July 15, 1999, to present
ECD Landfill Ellis County	Type 1, MSW No. 1745B	1988 to present
Fort Worth Regional Landfill Tarrant County	Type 1, MSW No. 464A	Mar. 1987 to Oct. 1995 (CLOSED)
Fort Worth Transfer Station Tarrant County	Type V, MSW No. 2275	2001 to present
Greenwood Farms Landfill Smith County	Type 1, MSW No. 1972A	Sept. 1988 to present
Hutchins Landfill Dallas County	Type 1, MSW No. 1236A	CLOSED in 1992
Itasca Landfill Hill County	Type 1, MSW No. 241D	1988 to present
Lewisville Landfill Denton County	Type 1V, MSW No. 1749B	1986 to present
Maloy Landfill Hunt County	Type 1, MSW No. 1195B	January 23, 1979, to present
Mexia Landfill Limestone County	Type 1, MSW No. 1558A	1983 to present
Mill Creek Landfill Tarrant County	Type 1, MSW No. 208A	1973 to Nov. 2001 (CLOSED)

**Table E-1 (Continued)**  
**Texas Solid Waste Facilities**  
**Republic Services, Inc.**  
**(as of April 2022)**

Name & Location	Permit Type & No.	Dates of Operation <sup>1</sup>
<b>NORTH TEXAS AREA (Continued)</b>		
Pinehill Landfill Gregg County	Type 1, MSW No. 1327B	Dec. 1987 to present
Pleasant Oaks Landfill Titus County	Type 1, MSW No. 797B	1960 to present
Quail Canyon Landfill Lubbock County	Type 1, MSW No. 987A	1977 to 1992 (CLOSED)
Royal Oaks Landfill Cherokee County	Type 1, MSW No. 1614A	Dec. 1988 to present
Trinity Oaks Landfill Dallas County	Type 1, MSW No. 556	1976 to Nov. 2002 (CLOSED)
<b>SOUTH TEXAS AREA</b>		
BFI Burnet TS Burnet County	Registration No. 40035	Aug. 17, 1994 to present
BFI Sealy TS Austin County	Registration No. 40025	April 19, 1995 to present
BFI Corpus Christi Recyclery Nueces County	Registration No. 65019	July 31, 2002 to present
BFI Galveston County TS Galveston County	Registration No. 1680	Oct. 4, 1989 to present
Blue Ridge Landfill Fort Bend County	Type 1, MSW No. 1505A	Dec. 10, 1990, to present
Cefe Valenzuela Landfill Nueces County	Type 1, MSW No. 2269	July 22, 2005 to present
City of El Campo CCS Wharton County	Type 5CC, MSW No. 120025	March 17, 2009, to present
El Centro Landfill Nueces County	Type 1, MSW No. 2267	2003 to present
Galveston County Landfill Galveston County	Type 1, MSW No. 1149B	January 14, 1971, to present
Golden Triangle Landfill Jefferson County	Type 1, MSW No. 2027	May 24, 1991, to present
Gulf West Landfill Chambers County	Type 1, MSW No. 39039	March 1991 to present
Hardin County Landfill Hardin County	Type 1, MSW No. 2214A	September 2017 to the present
Holmes Road Landfill Harris County	Type 1, MSW No. 38 (N ½) & MSW No. 377 (S ½)	CLOSED in 1978
Houston Northwest TS Harris County	Type 5TS, MSW No. 1092	Jan. 12, 1999 to present
Houston Southeast TS Harris County	Type 5TS, MSW No. 1074	December 22, 1983, to present
Houston Southwest TS Harris County	Type 5TS, MSW No. 1091	November 23, 1977, to present

**Table E-1 (Continued)**  
**Texas Solid Waste Facilities**  
**Republic Services, Inc.**  
**(as of April 2022)**

Name & Location	Permit Type & No.	Dates of Operation <sup>1</sup>
<b>SOUTH TEXAS AREA (Continued)</b>		
Kerrville Landfill Kerr County	Type 1, MSW No. 1506A	1984 to present
La Feria TS Cameron County	Type 5TS, MSW No. 2375	November 9, 2011, to present
La Gloria Ranch Landfill Hidalgo County	Type 1, MSW No. 2348	May 24, 2007, to present
La Porte LF Harris County	Type 1, MSW No. 1765	Closed in 1988
McCarty Road Landfill Harris County	Type 1, MSW No. 261B	1972 to present
North County Landfill Galveston County	Type 4, MSW No. 1849B	April 24, 1998, to present
Pinn Road 1 Landfill Bexar County	Type 1 and IV, MSW No. 92	Type 1: 1975 to April 1986; revised to Type 1V to Sept. 1991 (CLOSED)
Pinn Road 2 Landfill Bexar County	Type 1, MSW No. 14	Jul. 1975 to 1994 (CLOSED)
Port Arthur Landfill Jefferson County	Type 1, MSW No. 1815	CLOSED in 1985
Rio Grande Valley Landfill Hidalgo County	Type 1, MSW No. 1948	Jan. 19, 1994, to present
Sinton Landfill San Patricio County	Type 1, MSW No. 242A	Sept. 8, 1972, to 2003 (CLOSED)
Sunset Farms Landfill Travis County	Type 1, MSW No. 1447A	May 17, 1982, to present
Tessman Road Landfill Bexar County	Type 1, MSW No. 1410B	1981 to present
Total Roll-Offs TS Washington County	Registration No. 40173	Sept. 4, 2001 to present
Victoria Landfill Victoria County	Type 1, MSW No. 1522A	Nov. 15, 1982, to present
Whispering Pines Landfill Harris County	Type 1, MSW No. 1193	Jan. 1, 1984, to present

<sup>1</sup>This list includes the approximate dates of operation of the facility. This includes the previous owner/operators of certain facilities prior to the facility being acquired by Republic Services, or its subsidiaries.

**Table E-2**  
**List of Republic Services Solid Waste Sites in States Other Than Texas**  
**(as of November 2012)**

Facility Name	Location		Facility Type	Dates of Operation <sup>a</sup>
Mobile TS	Mobile	AL	TS	June 1980 to Present
Marshall County TS	Albertville	AL	TS	March 1999 to Present
Andalusia TS	Andalusia	AL	TS	April 2000 to Present
BFI Waste Services of Anniston / Albertville TS	Albertville	AL	TS	June 2003 to Present
Little Creek TS	Guin	AL	TS	December 1999 to Present
BFI Waste Services of Greenville	Greenville	AL	TS	December 1993 to Present
BFI Huntsville MRF	Huntsville	AL	MRF	December 1975 to Present
Prattville C&D Landfill	Prattville	AL	LF	November 2004 to Present
Prattville Transfer Station	Prattville	AL	TS	December 1999 to Present
BFI Athens TS	Athens	AL	TS	December 1999 to Present
BFI Selma TS	Selma	AL	TS	May 1995 to Present
Brundidge LF	Brundidge	AL	LF	May 2000 to Present
Chilton Landfill	Clanton	AL	CLF	Closed
Sand Valley LF	Collinsville	AL	LF	May 2000 to Present
Greenville TS	Greenville	AL	TS	December 1993 to Present
Morris Farms LF	Hillsboro	AL	LF	June 1996 to Present
Pineview LF	Dora	AL	LF	March 1993 to Present
Tallegada TS	Lincoln	AL	TS	December 1999 to Present
Timberlands LF	Brewton	AL	LF	August 1993 to Present
Willow Ridge LF	Haleyville	AL	LF	May 2000 to Present
Bella Vista Hauling & TS	Bella Vista	AR	TS	August 1996 to Present
Model Fill LF	Little Rock	AR	LF	February 1991 to Present
7th Street TS	Phoenix	AZ	TS	*
7th Street MRF	Phoenix	AZ	MRF	*
Central Arizona Transfer	Queen Creek	AZ	TS	December 1999 to Present
Cave Creek Transfer Station	Phoenix	AZ	TS	December 1999 to Present
Aztec Waste	Phoenix	AZ	TS	December 1999 to Present
Apache Junction LF	Apache Junction	AZ	LF	October 1993 to Present
Cactus Landfill	Eloy	AZ	LF	December 2004 to Present
Chandler LF Services	Chandler	AZ	LF	August 1982 to Present
Cocopah Landfill	Somerton	AZ	CLF	Closed
Copper Mountain LF	Wellton	AZ	LF	June 2000 to Present
La Paz County LF	Parker	AZ	LF	November 1993 to Present
Lake Havasu LF Services	Lake Havasu	AZ	LF	May 1997 to Present
Mesa TS	Queen Creek	AZ	TS	*
Mohave Valley LF	Fort Mohave	AZ	LF	October 1996 to Present
Paradise Waste TS	Phoenix	AZ	TS	January 1998 to Present
Allied Waste Transfer Services of Page	Page	AZ	TS	April 1997 to Present
Queen Creek LF	Queen Creek	AZ	CLF	Closed
Southwest Regional LF	Buckeye	AZ	LF	December 1994 to Present
Suburban Transfer	Yuma	AZ	TS	April 2000 to Present
Seagull Sanitation Systems	Avalon	CA	LF	April 2001 to Present
West Contra Costa Sanitary Landfill (WCCSL)	Richmond	CA	LF	Closed
Barrett Junction Burn Site	Dulzura	CA	LF	July 2000 to Present
Boulevard Burn Site	Boulevard	CA	LF	*
Campo Burn Site	Campo	CA	LF	July 2000 to Present
ECDC LF Group - Northwest	San Francisco	CA	LF	*
ECDC LF Group - Southwest	Newport Beach	CA	LF	*
Julian Burn Site	Julian	CA	LF	Closed
Palomar Mountain Burn Site	Palomar Mountain	CA	LF	Closed
Ranchita Burn Site	Ranchita	CA	LF	August 1998 to Present
Viejas Burn Site	Alpine	CA	LF	Closed
Independent Trucking	Stockton	CA	TS	*

**Table E-2 (Continued)**  
**List of Republic Services Solid Waste Sites in States Other Than Texas**  
**(as of November 2012)**

Facility Name	Location		Facility Type	Dates of Operation <sup>a</sup>
American Waste TS	San Carlos	CA	TS	April 1998 to Present
Bel-Art TS	Gardena	CA	TS	May 1995 to Present
Del Norte Regional Recycling and Transfer Station	Oxnard	CA	TS	June 1999 to Present
LA Consolidated East LA Transfer Station	Los Angeles	CA	TS	*
West County Resource Recovery	Richmond	CA	TS	*
Vallecito TS	Julian	CA	TS	December 1999 to Present
Sunshine Summit TS	Warner Springs	CA	TS	December 1999 to Present
Ocotillo Wells TS	Borrego Springs	CA	TS	December 1999 to Present
French Camp LF	Stockton	CA	CLF	Closed
Central LA Recycling and Transfer Station	Los Angeles	CA	TS	December 1999 to Present
Azusa Land Reclamation	Azusa	CA	CLF	Closed
Vasco Road LF	Livermore	CA	LF	December 1999 to Present
BFI Compton TS	Compton	CA	TS	September 1989 to Present
BFI Falcon TS	Wilmington	CA	TS	July 1997 to Present
BFI Mussel Rock TS	Daly City	CA	TS	January 1995 to Present
BFI Pescadero TS	Pescadero	CA	TS	December 1996 to Present
BFI Rice Road MRF	Fresno	CA	MRF	February 1990 to Present
BFI Rice Road TS	Fresno	CA	TS	February 1990 to Present
BFI San Carlos TS	San Carlos	CA	TS	June 1968 to Present
Allied Waste Transfer of San Mateo County	San Carlos	CA	TS	June 1968 to Present
Borrego Springs LF	Borrego Springs	CA	LF	October 1997 to Present
Chateau Fresno LF	Fresno	CA	CLF	Closed
Chestnut Avenue LF	Fresno	CA	CLF	Closed
Contra Costa Transfer	Martinez	CA	TS	March 1994 to Present
Devlin Road TS & Recycling Facility	American Canyon	CA	TS	February 1994 to Present
Elder Creek Recovery and Trash Station	Sacramento	CA	TS	May 2000 to Present
Elder Creek Recovery and Trash Station	Sacramento	CA	MRF	May 2000 to Present
Forward LF	Manteca	CA	LF	March 1973 to Present
Allied Imperial LF	Imperial	CA	LF	April 2000 to Present
Keller Canyon LF	Pittsburgh	CA	LF	September 1991 to Present
Newby Island LF	Milpitas	CA	LF	August 1987 to Present
Otay LF	Chula Vista	CA	LF	October 1997 to Present
Ox Mountain LF	Half Moon Bay	CA	LF	June 1987 to Present
Palomar TS	Carlsbad	CA	TS	November 1997 to Present
Ramona LF	Ramona	CA	LF	October 1997 to Present
Ranchita TS	Ranchita	CA	TS	Closed
Allied Waste Recyclery of San Mateo County	San Carlos	CA	MRF	October 1991 to Present
Sunshine Canyon LF	Sylmar	CA	LF	March 1955 to Present
Sycamore Canyon LF	Santee	CA	CLF	Closed
The Recyclery at Newby Island	Milpitas	CA	MRF	August 1987 to Present
Valley Environmental MRF	El Centro	CA	MRF	June 2000 to Present
BFI Glenwood Springs TS	Glenwood Springs	CO	TS	December 1999 to Present
Washington Street TS	Denver	CO	TS	December 1999 to Present
BFI Glenwood Springs TS	Glenwood Springs	CO	TS	December 1991 to Present
Greeley TS	Greeley	CO	TS	November 1995 to Present
Boulder LF	Boulder	CO	CLF	Closed
Basalt TS	Basalt	CO	TS	January 1999 to Present
Denver Regional LF North	Erie	CO	CLF	Closed
Foothills LF	Golden	CO	LF	September 1992 to Present
Grand Junction Recyclery	Grand Junction	CO	MRF	February 1982 to Present
Jeffco 1 LF		CO	CLF	Closed
Tower LF	Commerce City	CO	LF	November 1982 to Present
ADS of Connecticut - Stratford	Stratford	CT	TS	December 1999 to Present



**Table E-2 (Continued)**  
**List of Republic Services Solid Waste Sites in States Other Than Texas**  
**(as of November 2012)**

Facility Name	Location		Facility Type	Dates of Operation <sup>a</sup>
PM Services Transfer	Hartford	CT	TS	December 1999 to Present
Capitol Recycling & Brokerage	Hartford	CT	MRF	November 1990 to Present
BFI Consolidated TS	WASHINGTON	DC	TS	
BFI Waste Services of Washington (Consolidated TS)	Washington	DC	TS	September 1994 to Present
545 Landfill	Winter Garden	FL	LF	*
Cedar Trail Landfill	Bartow	FL	LF	*
Nine Mile Road	St. Augustine	FL	LF	*
Metro Recycling	Tampa	FL	TS	*
Envirocycle	Ft. Lauderdale	FL	MRF	*
Rocket Blvd Material Recovery Facility	Orlando	FL	MRF	*
Southland Recycling Services	Jacksonville	FL	MRF	*
Buckeye Landfill (CLOSED TO PUBLIC)	Perry	FL	LF	December 1999 to Present
BFI Sarasota TS	Sarasota	FL	TS	December 1999 to Present
Delta Lakefill	Pompano Beach	FL	LF	December 1999 to Present
Key West Recyclery	Key West	FL	MRF	December 1999 to Present
Miami Beach TS	Miami Beach	FL	TS	December 1999 to Present
Pensacola TS	Pensacola	FL	TS	December 1999 to Present
Royal Oaks Ranch C&D LF	Terryville	FL	CLF	Closed
Tall Pines Recycling	W Palm Beach	FL	MRF	December 1999 to Present
BFI Pasco Recyclery	New Port Richey	FL	MRF	Closed
Pensacola TS	Pensacola	FL	TS	January 1990 to Present
BFI Pensacola Recyclery	Pensacola	FL	MRF	January 1990 to Present
BFI Tampa Bay Recyclery	Clearwater	FL	MRF	December 1986 to Present
Cone Road LF C&D	Tampa	FL	LF	March 1991 to Present
Delta Dade TS	Miami	FL	TS	December 1998 to Present
Ft. Lauderdale MRF	Davie	FL	MRF	December 1991 to Present
Ft. Walton TS	Ft. Walton Beach	FL	TS	April 2002 to Present
Jacksonville MRF	Jacksonville	FL	MRF	October 1978 to Present
Jones Road LF (C&D)	Jacksonville	FL	LF	October 1989 to Present
McKay Bay TS	Tampa	FL	TS	December 2001 to Present
Miami MRF	Miami	FL	MRF	March 1990 to Present
Miami TS	Miami	FL	TS	March 1990 to Present
Nassau LF (C&D)	Callahan	FL	LF	August 2002 to Present
BFI Sarasota Recyclery	Sarasota	FL	MRF	September 1990 to Present
Broadhurst Environmental	Screven	GA	LF	*
Highway 78 C&D Landfill	Monroe	GA	LF	*
Oak Grove LF	Winder	GA	LF	*
Pine Ridge Recycling	Griffin	GA	LF	*
Savannah Regional Landfill	Port Wentworth	GA	LF	*
Speedway LF	Winder	GA	LF	*
Swift Creek Environmental	Macon	GA	LF	*
Evans Co, Transfer Station	Claxton	GA	TS	*
Lee Transfer Station	Austell	GA	TS	*
Mauldin Drive Transfer Station	Alpharetta	GA	TS	*
Newnan Transfer Station	Winder	GA	TS	*
BFI Fayette County TS	Fayetteville	GA	TS	December 1999 to Present
Inland Paper & Packaging LF	Rome	GA	LF	October 2001 to Present
NORTH GEORGIA TRANSFER STATION	Rome	GA	TS	December 1999 to Present
SSES Newnan	Newman	GA	TS	December 1999 to Present
Tifton TS	Tifton	GA	TS	December 1999 to Present
BFI East Point TS	E. Point	GA	TS	January 1996 to Present
BFI Marble Mill TS	Marietta	GA	TS	August 1991 to Present
BFI Smyrna TS	Smyrna	GA	TS	January 1991 to Present

**Table E-2 (Continued)**  
**List of Republic Services Solid Waste Sites in States Other Than Texas**  
**(as of November 2012)**

Facility Name	Location		Facility Type	Dates of Operation <sup>a</sup>
BFI Waste Services of Atlanta/Smyrna TS	Smyrna	GA	TS	January 1991 to Present
East DeKalb LF (C&D)	Lithonia	GA	LF	January 1992 to Present
Fayette County LF (C&D)	Fayetteville	GA	CLF	Closed
Gateway LF	Ringgold	GA	CLF	Closed
Golden Waste Disposal/Tifton TS	Tifton	GA	TS	June 1998 to Present
Hickory Ridge LF	Conley	GA	LF	September 1992 to Present
Richland Creek LF	Buford	GA	LF	November 1995 to Present
Roberts Road LF	Fayetteville	GA	CLF	Closed
Southern States TS	Thomaston	GA	TS	July 1996 to Present
Southern States TS	Columbus	GA	TS	December 1993 to Present
Taylor County LF	Mauk	GA	LF	September 1987 to Present
Watts Road LF	Atlanta	GA	CLF	Closed
Wayne County Regional Landfill	Screven	GA	LF	*
Delaware Transfer Station	Manchester	IA	TS	December 1999 to Present
Hawkeye TS	Clinton	IA	TS	December 1999 to Present
Dubuque MRF	Dubuque	IA	MRF	December 1995 to Present
Hawkeye Disposal	Clinton	IA	TS	July 1998 to Present
Hawkeye Disposal	Maquoketa	IA	TS	January 1999 to Present
Boise TS	Boise	ID	TS	December 1999 to Present
C.C. LF	Danville	IL	LF	*
Southern Illinois Regional Landfill	DeSoto	IL	LF	*
Suburban Warehouse	Riverdale	IL	LF	*
AWS - Northlake TS	Northlake	IL	TS	*
Marion TS	Marion	IL	TS	*
Sparta TS	Sparta	IL	TS	*
Alliance Waste Services - Rockford	Belleville	IL	TS	December 1999 to Present
Alliance Waste Services - Rockford MRF	Rockford	IL	MRF	December 1999 to Present
Bloomington TS	Bloomington	IL	TS	December 1999 to Present
Bond County Landfill	Greenville	IL	LF	October 2003 to Present
Dukane TS	W Chicago	IL	TS	December 1999 to Present
Evanston TS	Evanston	IL	TS	December 1999 to Present
Kankakee Quarry	Momence Township	IL	CLF	Closed
LandComp LF	Ottawa	IL	LF	November 2002 to Present
Litchfield-Hillsboro LF	Litchfield	IL	LF	November 1998 to Present
Loop Recycling #1	Chicago	IL	MRF	December 1999 to Present
Melrose Park Transfer Station	Melrose Park	IL	TS	December 1999 to Present
Palatine MRF	Palatine	IL	MRF	December 1999 to Present
Planet Resources	Chicago	IL	MRF	December 1999 to Present
Robbins Transfer Station	Robbins	IL	TS	December 1999 to Present
Rolling Meadows TS	Rolling Meadows	IL	TS	December 1999 to Present
Southern Illinois TS (Metropolis)	Metropolis	IL	TS	December 1999 to Present
Speelman TS	Chicago	IL	TS	December 1999 to Present
Spoon Ridge LF	Fairview	IL	LF	July 1999 to Present
Tri-State MRF	Northlake	IL	MRF	December 1999 to Present
Urbana TS	Urbana	IL	TS	December 1999 to Present
Zion LF - Site 1A	Zion	IL	LF	December 1999 to Present
Zion LF, Site 1 - Phase B	Zion	IL	CLF	Closed
Zion LF, Site 2 (Old)	Zion	IL	LF	December 1999 to Present
34th Street Sorting Center	Chicago	IL	MRF	February 2003 to Present
Bloomington TS	Bloomington	IL	TS	November 1997 to Present
Apollo TS	Momence	IL	TS	April 1996 to Present
Belleville LF	Belleville	IL	CLF	Closed
BFI Elk Grove Recyclery	Elk Grove Village	IL	MRF	February 1996 to Present

**Table E-2 (Continued)**  
**List of Republic Services Solid Waste Sites in States Other Than Texas**  
**(as of November 2012)**

Facility Name	Location		Facility Type	Dates of Operation <sup>a</sup>
BFI Quad Cities LF - Phase 1/2	Milan	IL	CLF	Closed
BFI Quad Cities LF - Phase 3	Milan	IL	CLF	March 1983 to Present
Brickyard Disposal	Danville	IL	LF	November 1995 to Present
Brickyard Unit #1	Danville	IL	CLF	Closed
Calumet TS	Chicago	IL	TS	May 1997 to Present
Urbana TS	Urbana	IL	TS	February 1996 to Present
Citiwaste TS (C&D Only)	Joliet	IL	TS	March 1996 to Present
City of Paris TS	Paris	IL	TS	December 1998 to Present
Congress Development Company	Hillside	IL	LF	March 1974 to Present
D&L Disposal	Greenville	IL	TS	April 1996 to Present
Davis Junction LF	Davis Junction	IL	CLF	Closed
Dixon/GROP LF No. 2	Dixon	IL	CLF	Closed
Envirotech LF	Morris	IL	LF	December 1986 to Present
Envotech LF	Litchfield	IL	LF	April 1996 to Present
ERC / Coles County LF	Charleston	IL	LF	June 2000 to Present
Groen TS	Crestwood	IL	TS	June 1981 to Present
Herrin TS	Herrin	IL	TS	May 1994 to Present
Illini Recycling	Champaign	IL	MRF	April 1996 to Present
Illinois LF	Hoopeston	IL	LF	December 1991 to Present
Illinois Valley Recycling	Ottawa	IL	MRF	July 2000 to Present
Illinois Waste System LF	Milford	IL	CLF	Closed
Jersey Sanitation LF	Jerseyville	IL	CLF	Closed
K&H Disposal	Donovan	IL	CLF	Closed
Lee County LF	Dixon	IL	LF	October 1997 to Present
Livingston LF	Pontiac	IL	LF	August 2001 to Present
Loop Recycling (64th Street)	Chicago	IL	MRF	August 1998 to Present
Loop Recycling (Laflin Street)	Chicago	IL	MRF	September 1994 to Present
Loop Transfer (Laflin Street)	Chicago	IL	TS	August 1998 to Present
Loop Transfer (64th Street)	Chicago	IL	TS	August 1998 to Present
Mallard Lake LF	Hanover Park	IL	CLF	Closed
McCook TS	McCook	IL	TS	September 1996 to Present
McLean County LF	Bloomington	IL	LF	November 1997 to Present
Medill Sorting Center	Chicago	IL	MRF	February 2003 to Present
Midtown TS	Chicago	IL	TS	June 1982 to Present
Modern LF (Belleville) (MIG/DEWANE)	Belleville	IL	CLF	Closed
New Age Recycling	Danville	IL	MRF	October 1988 to Present
North Chicago LF	North Chicago	IL	CLF	Closed
Northwest Sorting Center	Chicago	IL	MRF	February 2003 to Present
Okaw Valley Recycling	Sullivan	IL	MRF	April 1999 to Present
Planet Recovery	Chicago	IL	TS	January 1992 to Present
Planet Recovery MRF	Chicago	IL	MRF	January 1992 to Present
RCS LF	Jerseyville	IL	LF	January 1993 to Present
Roxana LF	Edwardsville	IL	LF	October 1985 to Present
Roxana MRF	Edwardsville	IL	MRF	October 1985 to Present
Saline County LF	Harrisburg	IL	LF	May 1999 to Present
Sangamon Valley LF	Springfield	IL	LF	November 1999 to Present
Shred-All Recycling	Chicago	IL	TS	December 1995 to Present
Shred-All Recycling & Transfer	Chicago	IL	TS	September 1997 to Present
Shred-All TS	Chicago	IL	TS	December 1995 to Present
South Barrington LF	South Barrington	IL	CLF	Closed
Streator Area LF	Streator	IL	LF	December 1991 to Present
Upper Rock Island LF	East Moline	IL	LF	October 1994 to Present
Watts-Springfield Unit 1 LF	Springfield	IL	CLF	Closed

**Table E-2 (Continued)**  
**List of Republic Services Solid Waste Sites in States Other Than Texas**  
**(as of November 2012)**

Facility Name	Location		Facility Type	Dates of Operation <sup>a</sup>
Wayne County LF	Fairfield	IL	LF	June 1997 to Present
National Serv-All Landfill	Fort Wayne	IN	LF	*
Sycamore Ridge Landfill	Pimento	IN	LF	*
Wabash Valley Landfill	Wabash	IN	LF	*
Advantage Transfer Station	Huntingburg	IN	TS	*
Circle City Recycling	Indianapolis	IN	TS	*
National Serv-ALL/Scott TS	Shipshewana	IN	TS	*
National Serv-ALL TS	Auburn	IN	TS	*
Vincennes TS	Vincennes	IN	TS	*
C.A.R.E.	Fort Wayne	IN	MRF	*
EAST CHICAGO COMPOST	East Chicago	IN	MRF	*
Republic Services - Langsdale Recycling	Indianapolis	IN	MRF	*
Blackfoot LF	Winslow	IN	LF	December 1999 to Present
Clinton County Landfill	Frankfort	IN	LF	May 2004 to Present
Illiana Transfer Station - Crown Point	Crown Point	IN	TS	December 1999 to Present
Illiana Transfer Station III	Crown Point	IN	TS	December 1999 to Present
Key Waste MRF	Culver	IN	MRF	December 1999 to Present
Koester TS	Evansville	IN	TS	December 1999 to Present
Metropolitan Landfill	Albany	IN	CLF	Closed
County Line LF	Argos	IN	LF	April 1994 to Present
Illiana Waste Transfer Station I	Schererville	IN	TS	January 1994 to Present
Illiana Waste Transfer Station II	East Chicago	IN	TS	February 2002 to Present
Illiana Waste Transfer Station IV	Lake Station	IN	TS	August 1998 to Present
Kosciusko County LF	Claypool	IN	LF	February 1998 to Present
Lake County C&D LF	Lowellville	IN	LF	June 1988 to Present
Laubascher Meadow LF	Evansville	IN	LF	October 1982 to Present
Newton County Development LF	Brook	IN	LF	February 1996 to Present
Ooms Brothers TS	DeMotte	IN	TS	December 1994 to Present
Springfield Environmental C&D LF	Mt Vernon	IN	LF	April 2000 to Present
Tri-County TS	Covington	IN	TS	June 1994 to Present
United Refuse Landfill	Fort Wayne	IN	LF	*
Finney County LF	Garden City	KS	CLF	Closed
American Disposal Services - Galena	Galena	KS	TS	February 1996 to Present
Forest View Landfill	Kansas City	KS	CLF	Closed
Resource Recovery LF	Cherryvale	KS	LF	April 1986 to Present
Wheatland LF	Columbus	KS	LF	March 1997 to Present
Dozit Company	Morganfield	KY	LF	October 1993 to Present
Epperson Waste Disposal	Williamstown	KY	LF	March 1992 to Present
Ohio County Balefill	Beaver Dam	KY	LF	*
Tri-K Landfill	Stanford	KY	LF	April 1992 to Present
Valley View Landfill	Sulpher	KY	LF	August 1999 to Present
Blue Grass Waste Alliance	Lexington	KY	TS	February 2003 to Present
CSI Covington TS	Covington	KY	TS	*
CWI of Kentucky - Paducah TS	Paducah	KY	TS	June 2003 to Present
Daviess County Solid Waste	Owensboro	KY	TS	June 2002 to Present
Dozit Company - Henderson Transfer	Henderson	KY	TS	*
Ohion County Balefill - City of Hopkinsville	Hopkinsville	KY	TS	*
Kenneday Road (merged w/ div 993)	Lexington	KY	TS	December 1999 to Present
Louisville Recyclery	Louisville	KY	MRF	December 1999 to Present
Mother Earth LF	Louisville	KY	LF	December 1999 to Present
Bath County TS	Owingsville	KY	TS	May 2000 to Present
Benson Valley LF	Frankfort	KY	LF	July 2002 to Present
BFI Danville	Danville	KY	TS	May 2000 to Present

**Table E-2 (Continued)**  
**List of Republic Services Solid Waste Sites in States Other Than Texas**  
**(as of November 2012)**

Facility Name	Location		Facility Type	Dates of Operation <sup>a</sup>
BFI Elizabethtown TS	Elizabethtown	KY	TS	September 1990 to Present
Blue Ridge LF	Irvine	KY	LF	May 2000 to Present
Green Valley LF	Ashland	KY	LF	March 2000 to Present
Morehead LF	Morehead	KY	LF	May 2000 to Present
Stevens Dispos-All	Danville	KY	TS	May 2000 to Present
St. John Pickup Station	Laplace	LA	TS	December 1999 to Present
Sugarmill TS	Broussard	LA	TS	December 1999 to Present
Area 90 LF	Avondale	LA	CLF	Closed
Baton Rouge MRF	Baton Rouge	LA	MRF	December 1999 to Present
BFI Shreveport MRF	Shreveport	LA	MRF	February 2000 to Present
Carlyss LF	Carlyss	LA	CLF	Closed
CECOS - Calcasieu	Sulphur	LA	CLF	Closed
Colonial LF	Sorrento	LA	LF	November 1984 to Present
Crescent Acres LF	New Orleans	LA	CLF	Closed
East St. Charles LF	Kenner	LA	CLF	Closed
Geismar LF	Darrow	LA	CLF	Closed
Hackberry LF	Hackberry	LA	CLF	Closed
Jefferson Davis LF	Welsh	LA	LF	July 1989 to Present
New Orleans MRF	Metairie	LA	MRF	May 1974 to Present
North Baton Rouge LF	Zachary	LA	LF	November 1993 to Present
Siegen Lane LF	Baton Rouge	LA	CLF	Closed
Webster Parrish LF	Minden	LA	LF	February 2000 to Present
West Saint Charles LF	Boutte	LA	CLF	Closed
White Oaks LF	Monroe	LA	CLF	Closed
Woodland Hills LF	Sulphur	LA	CLF	Closed
Woolworth Road LF	Keithville	LA	LF	October 1986 to Present
Auburn Transcyclery	Auburn	MA	TS	December 1999 to Present
Cambridge TS	Cambridge	MA	TS	December 1999 to Present
Holliston LF	Holliston	MA	LF	December 1999 to Present
Holliston TS	Holliston	MA	TS	December 1999 to Present
Allied Waste Services of MA, LLC	Peabody	MA	TS	May 1997 to Present
BFI Brockton Recyclery	Brockton	MA	MRF	October 1984 to Present
BFI Howard TS	Roxbury	MA	TS	December 1976 to Present
BFI Waste Services of Tyngsboro	Tyngsboro	MA	TS	February 1993 to Present
Chicopee LF	Chicopee	MA	CLF	Closed
East Bridgewater LF	East Bridgewater	MA	CLF	Closed
Fall River LF	Fall River	MA	LF	March 1983 to Present
Halifax LF	Halifax	MA	CLF	Closed
McNamara Transfer	Springfield	MA	TS	July 1995 to Present
Oak Bluff - Tisbury	Oakbluffs	MA	TS	May 1993 to Present
Oak Bluff - Tisbury	Oakbluffs	MA	MRF	May 1993 to Present
BFI Peabody TS	Peabody	MA	TS	August 1990 to Present
Plainville LF	Plainville	MA	CLF	Closed
Randolph LF	Randolph	MA	CLF	Closed
Honey-Go-Run Reclamation	Perry Hall	MD	LF	*
BFI Elkridge Recyclery	Elkridge	MD	MRF	December 1999 to Present
Millenium	Baltimore	MD	MRF	December 1999 to Present
BFI Baltimore Processing Center	Baltimore	MD	MRF	July 1996 to Present
BFI Waste Services of Baltimore	Baltimore	MD	TS	December 1994 to Present
ERCA - Norris Farms LF	Baltimore	MD	CLF	Closed
BFI Hagerstown Recyclery	Hagerstown	MD	MRF	December 1981 to Present
Montgomery County	Derwood	MD	CLF	Closed
Oaks LF	Laytonsville	MD	CLF	Closed



**Table E-2 (Continued)**  
**List of Republic Services Solid Waste Sites in States Other Than Texas**  
**(as of November 2012)**

Facility Name	Location		Facility Type	Dates of Operation <sup>a</sup>
Quarantine LF	Baltimore	MD	CLF	Closed
Solley Road LF	Glen Burnie	MD	CLF	Closed
Maine Organics - Ops & Trucking	Unity	ME	MRF	December 1999 to Present
New England Organics	Falmouth	ME	MRF	December 1999 to Present
Carleton Farms LF	Carleton	MI	LF	*
Forest Lawn Landfill	Three Oaks	MI	LF	April 1993 to Present
Republic Services of Northern MI - Whitefeather LF	Pinconning	MI	LF	August 2002 to Present
Coldwater TS	Coldwater	MI	TS	*
Reliable Disposal of S. Haven	South Haven	MI	TS	May 2002 to Present
Republic Services - Cork Street TS	Kalamazoo	MI	TS	October 1999 to Present
Arbor Hills LF	Northville	MI	CLF	Closed
Arbor Hills Recyclery	Northville	MI	MRF	December 1999 to Present
B & R TS	Redford	MI	TS	December 1999 to Present
BFI of Western Michigan	Kalamazoo	MI	TS	December 1999 to Present
Detroit TS	Detroit	MI	TS	December 1999 to Present
Ford Assembly Plants TS	Wayne	MI	TS	December 1999 to Present
Kalamazoo Recyclery	Kalamazoo	MI	MRF	December 1999 to Present
KVG LF	Climax	MI	LF	December 1999 to Present
Schaefer Road TS	Dearborn	MI	TS	December 1999 to Present
SMDA TS	Roseville	MI	TS	December 1999 to Present
Taymouth Landfill	Birch Run	MI	LF	*
Utica Ford TS	Utica	MI	TS	December 1999 to Present
Adrian LF	Adrian	MI	CLF	Closed
Adrian LF	Adrian	MI	LF	January 1997 to Present
Kalamazoo TS	Kalamazoo	MI	TS	December 1999 to Present
C & C LF	Marshall	MI	LF	June 1982 to Present
Central Sanitary LF	Pierson	MI	LF	February 1996 to Present
Citizens Disposal LF	Grand Blanc	MI	LF	October 1988 to Present
Community Recycling Services	Muskegon	MI	MRF	June 2003 to Present
Dinverno MRF	Detroit	MI	MRF	January 1988 to Present
Hillsdale TS	Hillsdale	MI	TS	December 1996 to Present
Lyon Development LF	New Hudson	MI	CLF	Closed
Manistee County LF	Manistee	MI	LF	May 1989 to Present
Oakland Heights Development	Auburn Hills	MI	LF	March 1997 to Present
Ohio Demo LF (C&D Only)	Toledo	MI	LF	August 1972 to Present
Ottawa County Farms LF	Coopersville	MI	LF	September 2000 to Present
Rockwood LF	Newport	MI	LF	August 1997 to Present
Sauk Trail Hills LF	Canton	MI	LF	December 1983 to Present
Southfield Transfer Station	Southfield	MI	TS	December 1997 to Present
Sunset Waste Services - Hamilton	Hamilton	MI	TS	April 1999 to Present
Tri-City TS	Kalamazoo	MI	TS	December 1999 to Present
Vienna Junction LF	Erie	MI	LF	August 1999 to Present
Hennepin Transfer, Inc.	Inver Grove Heights	MN	TS	*
Eden Prairie Recyclery	Eden Prairie	MN	MRF	December 1999 to Present
Mall of America	Bloomington	MN	MRF	December 1999 to Present
Minden Transfer Station	St Cloud	MN	TS	December 1999 to Present
Woodlake LF	Medina	MN	CLF	Closed
BFI Brooklyn Park TS	Brooklyn Park	MN	TS	December 1999 to Present
BFI Flying Cloud TS	Eden Prairie	MN	TS	March 1972 to Present
BFI Hennepin TS	Burnsville	MN	TS	March 1990 to Present
BFI Waste Services of the Twin Cities	Brooklyn Park	MN	TS	December 1999 to Present
BFI Waste Services of the Twin Cities	Inver Grove Heights	MN	MRF	April 1988 to Present
BFI Waste Services of Twin Cities	Minneapolis	MN	MRF	September 1992 to Present

**Table E-2 (Continued)**  
**List of Republic Services Solid Waste Sites in States Other Than Texas**  
**(as of November 2012)**

Facility Name	Location		Facility Type	Dates of Operation <sup>a</sup>
Blaine TS	Blaine	MN	TS	December 2001 to Present
Flying Cloud LF	Eden Praire	MN	CLF	Closed
Bloomington TS	Bloomington	MN	TS	November 1997 to Present
Bloomington TS	Bloomington	MN	MRF	November 1997 to Present
Pine Bend LF	Inver Grove Heights	MN	LF	April 1991 to Present
Southwest Regional Sanitary LF	Jasper	MO	LF	March 2007 to Present
CWI - Potosi Transfer Station	Cadet	MO	TS	*
CWI of Missouri (Potosi)	Potosi	MO	TS	*
Bridgeton Transfer Station	Bridgeton	MO	TS	December 1999 to Present
Jefferson City TS	Jefferson City	MO	TS	December 1999 to Present
New Madrid	Dexter	MO	TS	December 1999 to Present
Saint Louis Recyclery	St Louis	MO	MRF	December 1999 to Present
Springfield Recyclery	Springfield	MO	MRF	December 1999 to Present
St Louis Waste TS	St Louis	MO	TS	December 1999 to Present
American Disposal Services - Ozarks	Springfield	MO	TS	February 1975 to Present
American Disposal Services - Reeds Spring	Reeds Spring	MO	TS	February 1975 to Present
American Disposal Services - Springfield	Springfield	MO	TS	February 1975 to Present
Backridge LF	LaGrange	MO	LF	December 1990 to Present
Bridgeton LF	Bridgeton	MO	LF	November 1985 to Present
Butler County LF Authority	Poplar Bluff	MO	LF	July 1980 to Present
Cass County TS	Harrisonville	MO	TS	Closed
Courtney Ridge LF	Sugar Creek	MO	LF	August 2000 to Present
Ellis-Scott LF	Clinton	MO	CLF	Closed
Jackson LF	Jackson	MO	CLF	Closed
Jackson TS	Jackson	MO	TS	October 1995 to Present
Jefferson City LF	Jefferson City	MO	LF	January 1998 to Present
Johnson County LF	Warrensburg	MO	CLF	Closed
Lamar LF (CLOSED SITE)	Lamar	MO	CLF	Closed
Lemons East Sanitary LF	Dexter	MO	LF	December 1992 to Present
Lemons LF West	Dexter	MO	CLF	Closed
Jefferson City TS	Jefferson City	MO	TS	January 1983 to Present
Midwest LF	Lonedell	MO	CLF	Closed
Missouri City LF	Liberty	MO	CLF	Closed
Missouri Pass LF	Maryland Heights	MO	CLF	Closed
Mo Pass (Yard Waste Transfer Station)	Maryland Heights	MO	TS	January 1988 to Present
Modern TS	Osage Beach	MO	TS	April 1999 to Present
Plattco LF	Parkville	MO	CLF	Closed
Prairieview Regional Waste Facility	Lamar	MO	LF	May 1997 to Present
Redbird LF	Arnold	MO	CLF	Closed
Show-Me Regional LF	Warrensburg	MO	LF	May 1991 to Present
Southeast LF	Kansas City	MO	CLF	Closed
St Louis TS	St. Louis	MO	TS	May 1986 to Present
St. Louis Jeffco L/F	Arnold	MO	CLF	Closed
Wayne County LF	Greenville	MO	CLF	Closed
BFI Biloxi Recyclery	Biloxi	MS	MRF	December 1999 to Present
BFI Biloxi TS	Biloxi	MS	TS	December 1999 to Present
BFI Vicksburg TS	Vicksburg	MS	TS	December 1999 to Present
MAGNOLIA C&D LF	Kiln	MS	LF	September 2005 to Present
Pleasant Hills LF	Olive Branch	MS	LF	July 1999 to Present
Three Rivers LF	Pontotoc	MS	LF	December 1999 to Present
BFI Marks TS	Marks	MS	TS	January 1994 to Present
BFI Waste Services of Hattiesburg	Hattiesburg	MS	TS	May 1993 to Present
BFI Waste Services of the Gulf Coast	Vancleave	MS	MRF	December 1999 to Present

**Table E-2 (Continued)**  
**List of Republic Services, Inc. Solid Waste Sites in States Other Than Texas**  
**(as of November 2012)**

Facility Name	Location		Facility Type	Dates of Operation <sup>9</sup>
BFI Biloxi TS	Biloxi	MS	TS	December 1999 to Present
Big River LF	Leland	MS	LF	October 1987 to Present
Gulf Pines LF	Biloxi	MS	CLF	Closed
Little Dixie LF	Ridgeland	MS	LF	August 1999 to Present
Missoula Recycling	Missoula	MT	MRF	*
BFI Waste Services of Missoula	Missoula	MT	MRF	December 1999 to Present
Boseman Recycle Now	Bozeman	MT	MRF	December 1999 to Present
Great Falls	Great Falls	MT	MRF	December 1999 to Present
Helena	Helena	MT	MRF	December 1999 to Present
Billings Recycling	Billings	MT	MRF	June 2004 to Present
BFI Waste Services of Billings	Billings	MT	MRF	August 1994 to Present
Missoula LF	Missoula	MT	LF	March 1971 to Present
BFI Waste Services of Missoula	Missoula	MT	MRF	December 1999 to Present
East Carolina Environmental	Aulander	NC	LF	*
Foothills Environmental	Lenoir	NC	LF	*
Upper Piedmont Environmental	Rougemont	NC	LF	*
Uwharrie Environmental	Mt. Gilead	NC	LF	*
Bishop Road TS	Greensboro	NC	TS	*
GDS - Conover MRF	Conover	NC	TS	*
Moore County TS	Aberdeen	NC	TS	*
Overdale Road TS	Winston-Salem	NC	TS	*
Richmond County	Rockingham	NC	TS	*
BFI Waste Services of Winston-Salem	Winston Salem	NC	MRF	December 1999 to Present
CCC - Charlotte	Charlotte	NC	TS	December 1999 to Present
Fayetteville TS	Fayetteville	NC	TS	December 1999 to Present
Sampson County LF	Roseboro	NC	LF	December 1999 to Present
Anson County LF	Polkton	NC	LF	April 2000 to Present
BFI Raleigh Recyclery	Raleigh	NC	MRF	December 1990 to Present
Cary TS	Cary	NC	TS	July 1994 to Present
Charlotte Motor Speedway LF	Concord	NC	LF	December 1986 to Present
City of Durham TS	Durham	NC	TS	October 1997 to Present
Holly Springs LF	Holly Springs	NC	LF	May 1991 to Present
Holly Springs LF	Holly Springs	NC	CLF	Closed
Lake Norman LF	Stanley	NC	LF	November 1998 to Present
Randolph County TS	Asheboro	NC	TS	January 1998 to Present
Rocky Mount TS	Rocky Mountain	NC	TS	August 1999 to Present
Yadkin County TS	Yadkinville	NC	TS	September 1993 to Present
NENSWC LF	Clarkson	NE	LF	December 1999 to Present
Fremont LF	Fremont	NE	CLF	Closed
Norfolk LF	Norfolk	NE	CLF	Closed
MA/NH/VT Organics Operations	Chichester	NH	MRF	December 1999 to Present
BFI Hooksett Recyclery	Hooksett	NH	MRF	November 1990 to Present
ECDC LF Group - Mid Atlantic	Tinton Falls	NJ	LF	*
A.R.T.S. Recycling	Linden	NJ	MRF	December 1999 to Present
Garofalo Recycling & T/S	Cresskill	NJ	TS	December 1999 to Present
Mount Laurel	Mt Laurel	NJ	TS	December 1999 to Present
A.M.S. Transfer Station	Linden	NJ	TS	January 1999 to Present
Di Rese TS	Tenafly	NJ	TS	January 1984 to Present
Fairview Street TS	Fairview	NJ	TS	February 1995 to Present
Garofalo TS	Garfield	NJ	TS	January 2000 to Present
Giordano Recycling	Port Newark	NJ	MRF	January 1997 to Present
Giordano Recycling	Port Newark	NJ	MRF	January 1997 to Present
Monroe Township LF	Monroe	NJ	CLF	Closed
Pedricktown LF	Pedricktown	NJ	CLF	Closed
Pelham LF	Pelham	NJ	CLF	Closed



**Table E-2 (Continued)**  
**List of Republic Services, Inc. Solid Waste Sites in States Other Than Texas**  
**(as of November 2012)**

Facility Name	Location		Facility Type	Dates of Operation <sup>a</sup>
Pinelands Park LF	Egg Harbor	NJ	CLF	Closed
South Brunswick	Monmouth	NJ	CLF	Closed
Apex Regional LF	Las Vegas	NV	LF	*
Laughlin LF	Laughlin	NV	LF	*
Cheyenne TS & Environmental Technologies	North Las Vegas	NV	TS	*
R.S. of S Nevada Recycle Center	North Las Vegas	NV	MRF	*
ECDC Logistics Office Northeast	Harrison	NY	LF	*
Staten Island TS	Staten Island	NY	TS	*
Bronx TS	Bronx	NY	TS	December 1999 to Present
Brooklyn TS	Brooklyn	NY	TS	December 1999 to Present
Champion TS	Bayshore	NY	TS	December 1999 to Present
Hempstead TS	Merrick	NY	TS	December 1999 to Present
Menands Transfer Station	Menands	NY	TS	December 1999 to Present
Scott Avenue MRF	Brooklyn	NY	MRF	December 1999 to Present
Scott Avenue TS C&D	Brooklyn	NY	TS	December 1999 to Present
Shepherd Avenue MRF	Brooklyn	NY	MRF	December 1999 to Present
Amsterdam LF	Fort Johnson	NY	CLF	Closed
BFI Schenectady TS	Schenectady	NY	TS	April 1993 to Present
BFI Southside TS	Depew	NY	TS	April 1975 to Present
Buffalo Recyclery	Buffalo	NY	MRF	February 1983 to Present
ERCA - Niagra Falls	Niagara Falls	NY	CLF	Closed
Fox Island TS	Port Chester	NY	TS	Closed
Hicksville MRF	Hicksville	NY	MRF	August 1997 to Present
Land Reclamation LF	Depew	NY	CLF	Closed
Mamaroneck TS	Mamaroneck	NY	TS	January 2000 to Present
Metro Enviro	Croton on the Hudson	NY	TS	March 2000 to Present
Mt. Kisco TS	Mt Kisco	NY	TS	August 1978 to Present
Niagara LF	Tonawanda	NY	CLF	Closed
Pine Avenue LF	Niagara Falls	NY	LF	January 1983 to Present
Recycling Industries Paper Division	Mamaroneck	NY	MRF	January 2000 to Present
Scott Avenue TS MSW	Brooklyn	NY	TS	June 1996 to Present
Selas TS	Holtsville	NY	TS	October 1989 to Present
Stanley Avenue TS	Brooklyn	NY	TS	June 1996 to Present
Thames Street TS	Brooklyn	NY	TS	October 1996 to Present
Watertown LF	Felts Mills	NY	CLF	Closed
Countywide R & D Landfill	East Sparta	OH	LF	*
Pine Grove Landfill	Amanda	OH	LF	*
Vienna Junction LF	Toledo	OH	LF	*
Ohio Demo LF (C&D Only)	Toledo	OH	LF	*
CSI Waste Services - Evansdale	Evansdale	OH	TS	*
National Serv-All Van Wert	Van Wert	OH	TS	*
Shelby County TS	Sidney	OH	TS	*
AWS Akron Recyclery	Akron	OH	MRF	December 1999 to Present
ERCA - Aber Road	Williamsburg	OH	CLF	Closed
Goshen Transfer	New Philadelphia	OH	TS	December 1999 to Present
Sandusky TS	Sandusky	OH	TS	January 1978 to Present
Bigfoot Run LF	Morrow	OH	CLF	Closed
Bobmeyer Road Demolition	Fairfield	OH	CLF	Closed
Bowers Phase II TS	Vickery	OH	TS	December 1990 to Present
Carbon Limestone LF	Lowellville	OH	LF	January 1999 to Present
Carbon Limestone TS	Lowellville	OH	TS	January 1999 to Present
Celina LF	Celina	OH	LF	December 1991 to Present
Cherokee Run LF	Bellefontaine	OH	LF	December 1997 to Present
Citrus LF	Malvern	OH	CLF	Closed
City of Amherst TS	Amherst	OH	TS	October 1998 to Present

**Table E-2 (Continued)**  
**List of Republic Services, Inc. Solid Waste Sites in States Other Than Texas**  
**(as of November 2012)**

Facility Name	Location		Facility Type	Dates of Operation <sup>a</sup>
CLD LF	Salem	OH	LF	January 1996 to Present
County Environmental Landfill of Wyandot	Carey	OH	LF	September 1996 to Present
Delaware TS	Delaware	OH	TS	February 1998 to Present
Duck Creek LF	Zanesville	OH	CLF	Closed
East Palestine LF	East Palestine	OH	CLF	Closed
Ford Road LF	Elyria	OH	CLF	Closed
Glenwillow LF	Glenwillow	OH	CLF	Closed
Glenwillow TS	Glenwillow	OH	TS	June 1996 to Present
Lorain Cnty Resource Recovery	Oberlin	OH	MRF	March 1992 to Present
Lorain Cnty Resource Recovery	Oberlin	OH	TS	March 1992 to Present
Lorain County II LF	Oberlin	OH	CLF	Closed
Lorain County LF	Oberlin	OH	LF	July 1986 to Present
Mansfield Transcyclery	Mansfield	OH	MRF	January 1999 to Present
Richland County TS	Mansfield	OH	TS	January 1999 to Present
Marion TS	Marion	OH	TS	Closed
Muskingum LF	Zanesville	OH	CLF	Closed
Oakland Marsh LF	Shiloh	OH	CLF	Closed
Ottawa County LF	Port Clinton	OH	LF	February 1974 to Present
Parris LF	Paris Township	OH	CLF	Closed
Robertsville C&D LF	Robertsville	OH	CLF	Closed
Ross Brothers TS	Mt Vernon	OH	TS	September 1996 to Present
Warner Hill LF	Garfield Heights	OH	CLF	Closed
Williams County LF	Bryan	OH	LF	December 1987 to Present
Willowcreek LF	Atwater	OH	CLF	Closed
Moore TS	Moore	OK	TS	December 1999 to Present
Stillwater Recycling	Stillwater	OK	MRF	October 2004 to Present
Stillwater Sanitary Landfill	Stillwater	OK	LF	October 2004 to Present
51 St LF	Broken Arrow	OK	CLF	Closed
Alderson Regional LF	Alderson	OK	LF	September 1991 to Present
Broken Arrow LF	Broken Arrow	OK	LF	Closed
Canadian Valley LF	Shawnee	OK	CLF	May 1984 to Present
Clinton TS	Clinton	OK	TS	November 1993 to Present
BFI Cushing TS	Cushing	OK	TS	June 1986 to Present
Fillsand LF	Oklahoma City	OK	CLF	Closed
Newcastle LF	Newcastle	OK	LF	June 1997 to Present
Oklahoma City MRF	Oklahoma City	OK	MRF	July 1993 to Present
Perkins LF	Perkins	OK	CLF	Closed
Pocasset LF	Pocasset	OK	LF	June 1997 to Present
Porter LF	Porter	OK	LF	September 1998 to Present
Southeast (OKC) LF	Oklahoma City	OK	LF	June 1955 to Present
Talala LF	Talala	OK	CLF	Closed
Weatherford TS	Weatherford	OK	TS	June 1997 to Present
Agri-Tech of Oregon	Albany	OR	LF	*
Albany - Lebanon Sanitation	Albany	OR	LF	*
Peltier Real Estate	Corvallis	OR	LF	*
Allied Waste Transportation Services	Woodburn	OR	TS	December 1999 to Present
Coffin Butte LF	Corvallis	OR	LF1	January 2000 to Present
Klamath Regional Disposal	Grants Pass	OR	TS	December 1999 to Present
BFI Metro Central TS & MRF	Portland	OR	MRF	June 1990 to Present
BFI Metro Central TS & MRF	Portland	OR	TS	June 1990 to Present
BFI Metro South TS	Oregon City	OR	TS	May 1982 to Present
Bio-Med of Oregon	Corvallis	OR	MRF	December 1999 to Present
Capitol Recycling & Disposal	Salem	OR	TS	June 1997 to Present
Grants Pass TS	Grants Pass	OR	TS	December 1999 to Present
Source Recycling	Albany	OR	MRF	July 1983 to Present

**Table E-2 (Continued)**  
**List of Republic Services, Inc. Solid Waste Sites in States Other Than Texas**  
**(as of November 2012)**

Facility Name	Location		Facility Type	Dates of Operation <sup>a</sup>
Valley Landfills Process and Recovery Center	Monmoth	OR	MRF	January 1997 to Present
Valley Landfills, Inc.	Monroe	OR	TS	January 1997 to Present
Valley View Landfill, Inc.	Corvallis	OR	LF	December 1991 to Present
Willamette Resources	Wilsonville	OR	MRF	October 1990 to Present
Willamette Resources TS	Wilsonville	OR	TS	October 1990 to Present
Modern Landfill	York	PA	LF	August 1997 to Present
McCusker/Ogborne Transfer	Chester	PA	TS	*
Quickway Transfer Station	Philadelphia	PA	TS	*
BFI Philadelphia TS	Philadelphia	PA	TS	December 1999 to Present
Conestoga Landfill	Morgantown	PA	LF	July 1999 to Present
Philadelphia Recyclery	Philadelphia	PA	MRF	December 1999 to Present
BFI River Road TS	Conshohocken	PA	TS	November 1990 to Present
BFI TRC TS	Philadelphia	PA	TS	December 1988 to Present
BFI Waste Services of Bucks - Mont	Fountainville	PA	MRF	December 1998 to Present
BFI Waste Services of Philadelphia	Philadelphia	PA	MRF	April 1993 to Present
BFI Waste Services of Philadelphia	Philadelphia	PA	TS	April 1993 to Present
County Environmental LF	Leeper	PA	CLF	Closed
Forestlawn LF	Clearfield	PA	CLF	Closed
Greenridge Reclamation LF	Scottdale	PA	LF	August 2001 to Present
Imperial LF	Imperial	PA	LF	May 1973 to Present
King of Prussia Recyclery	King of Prussia	PA	MRF	December 1999 to Present
Mon Valley LF	Charleroi	PA	CLF	Closed
BFI North Smithfield TS	N Smithfield	RI	TS	December 1999 to Present
Blackstone Valley Regional T/S	Pawtucket	RI	TS	December 1999 to Present
Standard Waste Services	Block Island	RI	TS	December 1999 to Present
BFI Waste Services of Rhode Island	North Smithfield	RI	TS	April 2001 to Present
Rose Hill Regional TS	South Kingstown	RI	TS	September 1989 to Present
Pepperhill C&D/Industrial Landfill	North Charleston	SC	LF	*
Spring Grove Landfill	North Charleston	SC	LF	*
Union County MSW Landfill	Enoree	SC	LF	*
Greenville TS	Duncan	SC	TS	December 1999 to Present
Anderson Regional LF	Belton	SC	LF	December 1997 to Present
Cherokee TS	Gaffney	SC	TS	August 1998 to Present
Ft. Mill TS	Ft. Mill	SC	TS	August 2001 to Present
Greer TS	Greer	SC	TS	December 2000 to Present
Jedburg LF	Jedburg	SC	CLF	Closed
Laurens County TS	Clinton	SC	TS	April 2000 to Present
Lee County LF	Bishopville	SC	LF	June 1997 to Present
Newberry County TS	Newberry	SC	TS	December 1993 to Present
Northeast Sanitary LF	Eastover	SC	LF	November 1996 to Present
White Street TS	Anderson	SC	TS	June 1993 to Present
Greenville Class II Landfill	Greenville	SC	LF	*
Northwest Tenn Disposal	Union City	TN	LF	*
Paris Landfill Station	Paris	TN	LF	*
Covington Waste	Covington	TN	TS	*
McKenzie Transfer Station	McKenzie	TN	TS	*
BFI Knoxville MRF	Knoxville	TN	MRF	December 1999 to Present
Chattanooga Transfer Station	Chattanooga	TN	TS	December 1999 to Present
JACKSON MADISON COUNTY C&D LANDFILL	Jackson	TN	LF	January 2006 to Present
JACKSON MADISON COUNTY LF	Jackson	TN	LF	January 2006 to Present
Memphis Recyclery	Memphis	TN	MRF	December 1999 to Present
Monroe County TS	Vonore	TN	TS	December 1999 to Present
AAA C&D TS	Nashville	TN	TS	August 1994 to Present
AAA M.S.W.	Nashville	TN	TS	August 1994 to Present
Carter Valley LF	Churchill	TN	LF	July 1985 to Present

**Table E-2 (Continued)**  
**List of Republic Services, Inc. Solid Waste Sites in States Other Than Texas**  
**(as of November 2012)**

Facility Name	Location		Facility Type	Dates of Operation <sup>a</sup>
Estill Springs TS	Estill Springs	TN	TS	January 1995 to Present
Fayetteville TS	Fayetteville	TN	TS	April 1995 to Present
Middle Point LF	Murfreesboro	TN	LF	October 1989 to Present
North Shelby LF	Millington	TN	LF	March 1997 to Present
Pulaski TS	Pulaski	TN	TS	May 1995 to Present
Safety Lights C&D LF	Memphis	TN	CLF	Closed
South Shelby LF	Memphis	TN	LF	May 1995 to Present
Sykes Road LF	Millington	TN	CLF	Closed
Twin Oaks LF	Knoxville	TN	CLF	Closed
Geneva Transfer Station	Salt Lake City	UT	TS	December 1999 to Present
Salt Lake City Transfer Station	Salt Lake City	UT	TS	December 1999 to Present
Utah County Recyclery (CLOSED)	Lindon	UT	MRF	December 1999 to Present
WASATCH REGIONAL LANDFILL	Salt Lake City	UT	LF	August 2005 to Present
BFI Salt Lake Recyclery	Salt Lake City	UT	MRF	March 1985 to Present
ECDC Environmental	East Carbon	UT	LF	December 1997 to Present
Washington County LF	St. George	UT	LF	July 1993 to Present
623 Landfill	Rockville	UT	LF	*
BFI Lorton Recyclery	Lorton	VA	MRF	December 1999 to Present
Norfolk Solid Waste TS	Norfolk	VA	TS	December 1999 to Present
Berryville LF	Berryville	VA	CLF	Closed
BFI Fluvanna Transcyclery	Fluvanna	VA	TS	November 1994 to Present
BFI Culpeper TS	Culpeper	VA	TS	May 1999 to Present
Roanoke TS	Roanoke	VA	TS	March 1994 to Present
BFI Goodwin TS	Yorktown	VA	TS	September 1999 to Present
BFI Westmoreland County TS	Montross	VA	TS	April 1994 to Present
Brunswick Waste Mgmt Facility	Lawrenceville	VA	LF1	November 1996 to Present
Fredricksburg TS	Fredricksburg	VA	TS	May 1994 to Present
King and Queen Sanitary LF	Little Plymouth	VA	LF	April 1993 to Present
Old Dominion LF	Richmond	VA	LF	October 1992 to Present
Richmond LF	Richmond	VA	CLF	Closed
Roanoke Recyclery	Roanoke	VA	MRF	March 1994 to Present
Telegraph Road LF	Lorton	VA	CLF	Closed
Tidewater TS	Chesapeake	VA	TS	February 1985 to Present
Rockingham LF	Rockingham	VT	CLF	Closed
Roosevelt Associates	West Roosevelt	WA	LF	*
Roosevelt Intermodal	Roosevelt	WA	LF	*
B Z Corners Drop Box	Husum	WA	TS	December 1999 to Present
Black River Transfer	Renton	WA	TS	December 1999 to Present
Dallesport Drop Box TS	Dallesport	WA	TS	January 1990 to Present
Ferry County TS	Republic	WA	TS	October 1997 to Present
Goldendale Drop Box TS	Goldendale	WA	TS	December 1999 to Present
Othello TS	Othello	WA	TS	July 1995 to Present
Pend Oreille, Central County TS	Usk	WA	TS	December 1994 to Present
Pend Oreille, South County TS	Newport	WA	TS	December 1994 to Present
Rabanco Intermodal, Ltd.	Husum	WA	TS	August 1993 to Present
Rabanco Recycling Co.	Seattle	WA	MRF	January 1988 to Present
Rabanco Recycling Co.	Seattle	WA	TS	January 1985 to Present
Black River Transfer	Renton	WA	TS	August 1991 to Present
Recomp of Washington / RDC Ferndale	Ferndale	WA	TS	October 1998 to Present
Ritzville TS	Ritzville	WA	TS	May 1995 to Present
Roosevelt Regional Ash Monofill	Roosevelt	WA	LF	June 1990 to Present
Roosevelt Regional MSW LF	Roosevelt	WA	LF	June 1990 to Present
Kestrel Hawk Landfill	Racine	WI	LF	*
Mallard Ridge Landfill	Delavan	WI	LF	*
Allied Waste Services of Hayward	Hayward	WI	TS	December 1999 to Present

**Table E-2 (Continued)**  
**List of Republic Services, Inc. Solid Waste Sites in States Other Than Texas**  
**(as of November 2012)**

Facility Name	Location		Facility Type	Dates of Operation <sup>a</sup>
BFI Park Falls TS	Park Falls	WI	TS	December 1999 to Present
Germantown	Germantown	WI	TS	December 1999 to Present
Kenosha Recyclery	Kenosha	WI	MRF	December 1999 to Present
Muskego	Muskego	WI	TS	December 1999 to Present
West Allis TS	West Allis	WI	TS	December 1999 to Present
BFI Siren TS	Webster	WI	TS	June 1993 to Present
BFI Waste Services of Northwest Wisconsin	Park Falls	WI	TS	December 1994 to Present
Lake Area (Permit #2054) LF	Sarona	WI	CLF	Closed
Lake Area (Permit #3144) LF	Sarona	WI	CLF	Closed
Lake Area (Permit #3474) LF	Sarona	WI	LF	March 1998 to Present
Troy Area LF	East Troy	WI	CLF	Closed
Fairmont MRF	Fairmont	WV	MRF	December 1999 to Present
Short Creek LF	Short Creek	WV	LF	December 1999 to Present
Sycamore LF	Hurricane	WV	LF	June 2001 to Present
West Bank Sanitation	Jackson	WY	TS	January 2001 to Present
Campo Sur LF	Ponce	PR	LF	*
Ponce LF	Ponce	PR	LF	*
Salinas LF	Salinas	PR	LF	*
BFI Catano TS	Catano	PR	TS	December 1999 to Present
Cidra TS	Cidra	PR	TS	*

LF = Active Landfill; CLF = Closed Landfill; TS = Transfer Station; MRF = Material Recovery Facility

<sup>a</sup> This list includes the approximate dates of operation of the facility. This includes the previous owners/operators of certain facilities prior to the facility being acquired by Republic Services, or its subsidiaries.

\* Initial date of ongoing operation is not clear from site records.

**Table E-3**  
**Regulatory Agencies for Republic Services Solid Waste Sites**

---

Alabama Department of Environmental Management (ADEM)  
P. O. Box 301463, Montgomery, AL 36130-1463

Arizona Department of Environmental Quality (ADEQ)  
1100 West Washington Street, Phoenix, AZ 85007-2935

Arkansas Department of Environmental Quality (ADEQ)  
Solid Waste Management Division  
5301 North Shore Drive, North Little Rock, AR 72118-5317

California Integrated Waste Management Board (CIWMB)  
Cal-EPA Building  
1001 I Street, P.O. Box 4025, Sacramento, CA 95812-4025

Colorado Department of Public Health and Environment (CDPHE)  
Hazardous Materials and Waste Management Division  
4300 Cherry Creek Drive South, Denver, CO 80246-1530

Connecticut Department of Environmental Protection (CDEP)  
Materials and Waste Management  
79 Elm Street, Hartford, CT 06106-5127

District Department of the Environment (DDOE)  
51 N Street, NE 6<sup>th</sup> Floor, Washington, DC 20002

Florida Department of Environmental Protection (FDEP)  
3900 Commonwealth Blvd., M.S. 49, Tallahassee, FL 32399

Georgia Department of Natural Resources  
Environmental Protection Division (EPD)  
2 Martin Luther King, Jr. Drive, Suite 1152 East Tower, Atlanta, GA 30334

Idaho Department of Environmental Quality (IDEQ)  
1410 North Hilton, Boise, ID 83706

Illinois Environmental Protection Agency (IEPA)  
1021 North Grand Avenue East, P.O. Box 19276, Springfield, IL 62794-9276

Indiana Department of Environmental Management (IDEM)  
Indiana Government Center North  
100 North Senate Avenue; Indianapolis, IN 46204-2251

Iowa Department of Natural Resources (IDNR)  
502 East 9<sup>th</sup> Street, Des Moines, IA 50319-0034



Kansas Department of Health and Environment (KDHE)  
Charles Curtis State Office Building  
1000 Southwest Jackson, Topeka, KS 66612

Kentucky Energy and Environment Cabinet  
Division of Waste Management, Department for Environmental Protection  
200 Fair Oaks Lane, Frankfort KY 40601

Louisiana Department of Environmental Quality (LDEQ)  
602 North Fifth Street, Baton Rouge, LA 70802

Maine Department of Environmental Protection (MDEP)  
17 State House Station, Augusta, ME 04333-0017

Maryland Department of the Environment (MDE)  
1800 Washington Boulevard, Baltimore, MD 21230

Massachusetts Department of Environmental Protection (MDEP)  
One Winter Street, 2<sup>nd</sup> Floor, Boston, MA 02108

Michigan Department of Environmental Quality (MDEQ)  
Waste Management Division  
Constitution Hall, 525 West Allegan Street, P.O. Box 30473, Lansing, MI 48909-7973

Minnesota Pollution Control Agency (MPCA)  
520 Lafayette Road North, St. Paul, MN 55155-4194

Mississippi Department of Environmental Quality (MDEQ)  
Solid Waste Policy, Planning, and Grants Branch  
515 East Amite Street, Jackson, MS 39201

Missouri Department of Natural Resources (MDNR)  
Waste Management Program, Division of Environmental Quality  
P.O. Box 176, Jefferson City, MO 65102

Montana Department of Environmental Quality (MDEQ)  
1520 East Sixth Avenue, P.O. Box 200901, Helena, MT 59620-0901

Nebraska Department of Environmental Quality (NDEQ)  
1200 "N" Street, Suite 400, P.O. Box 98922, Lincoln, NE 68509

Nevada Division of Environmental Protection (NDEP)  
901 South Stewart Street, Suite 4001, Carson City, NV 89701-5249

New Hampshire Department of Environmental Services (NHDES)  
Waste Management Division

29 Hazen Drive, P.O. Box 95, Concord, NH 03302-0095

New Jersey Department of Environmental Protection (NJDEP)  
401 East State Street, 7<sup>th</sup> Floor, East Wing, P.O. Box 402, Trenton, NJ 08625-0402

New York State Department of Environmental Conservation (NYSDEC)  
Division of Solid and Hazardous Materials  
625 Broadway, Albany, NY 12233-1010

North Carolina Department of Environment and Natural Resources (NCDENR)  
1601 Mail Service Center, Raleigh, NC 27699-1601

Ohio Environmental Protection Agency (OEPA)  
Division of Solid & Infectious Waste Management  
50 West Town Street, Suite 700, Columbus, OH 43215

Oklahoma Department of Environmental Quality (ODEQ)  
707 North Robinson, Oklahoma City, OK 73102

Oregon Department of Environmental Quality (ODEQ)  
Waste Prevention and Management Division  
811 Southwest Sixth Ave., Portland, OR 97204-1390

Pennsylvania Department of Environmental Protection (PDEP)  
Rachel Carson State Office Building  
400 Market Street, Harrisburg, PA 17101

Rhode Island Department of Environmental Management (RIDEM)  
235 Promenade St., Providence, RI 02908-5767

South Carolina Department of Health and Environmental Control (SCDHEC)  
2600 Bull St., Columbia, SC 29201

Tennessee Department of Environment and Conservation (TDEC)  
401 Church St., L&C Tower, Nashville, TN 37243-0435

Utah Department of Environmental Quality (UDEQ)  
Division of Solid and Hazardous Waste  
288 North 1460 West, 4th Floor, P. O. Box 144880, Salt Lake City, UT 84114-4880

Vermont Department of Environmental Conservation (DEC)  
Waste Management Division  
103 South Main Street, West Office Building, Waterbury, VT 05671-0404

Virginia Department of Environmental Quality (VDEQ)  
629 East Main Street, P.O. Box 1105, Richmond, VA 23218



Washington State Department of Ecology  
P. O. Box 47600, Olympia, WA 98504-7600

West Virginia Department of Environmental Protection (WVDEP)  
Division of Water and Waste Management  
601 57<sup>th</sup> Street SE, Charleston, WV 25304

Wisconsin Department of Natural Resources (WDNR)  
101 South Webster Street, P.O. Box 7921, Madison, WI 53707-7921

Puerto Rico Department of Natural and Environmental Resources  
P.O. Box 366147, San Juan, Puerto Rico 00936

**APPENDIX F**

**AFFECTED LANDOWNERS LIST AND MAP**

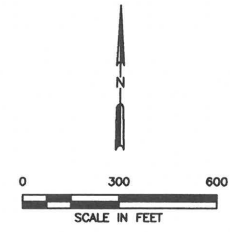
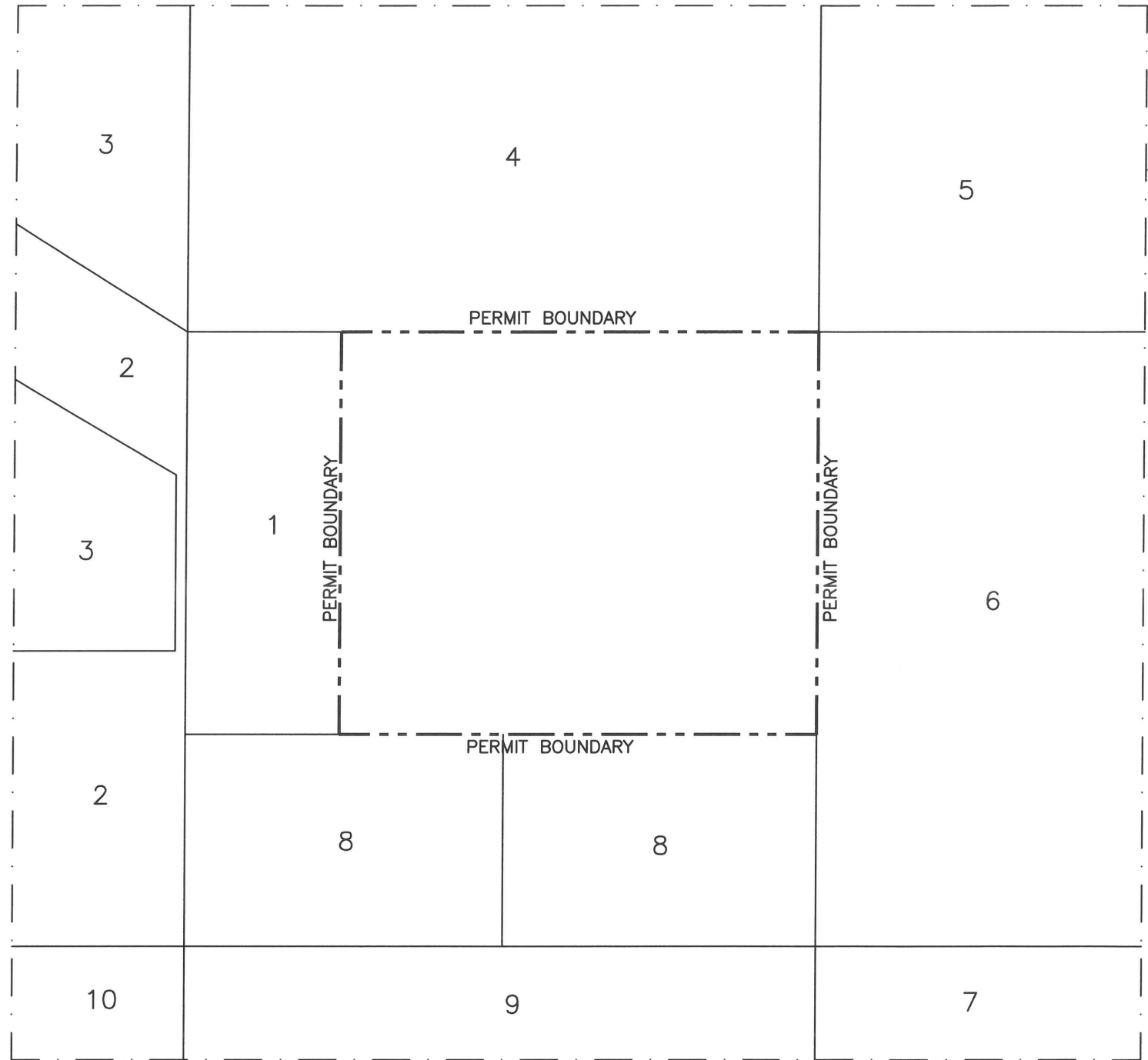

**LEGEND**  
 - - - - - PERMIT BOUNDARY  
 \_\_\_\_\_ ADJACENT PROPERTY BOUNDARY  
 . . . . . 1/4 MILE OFFSET FROM PERMIT BOUNDARY

**ADJACENT LANDOWNER LIST**

- |  |  |
|--|--|
| <p>1 PROPERTY OWNER NOT LISTED IN TERRY COUNTY APPRAISAL DISTRICT</p> <p>2 CITY OF MEADOW<br/>901 1ST ST<br/>MEADOW TX 79345</p> <p>3 LISA NIEMAN<br/>4610 55TH DR. #B<br/>LUBBOCK TEXAS 79414</p> <p>4 REPUBLIC WASTE SERVICES OF TEXAS, LTD.<br/>PO BOX 29246<br/>PHOENIX AZ 85038</p> <p>5 JIMMY PENDERGRASS<br/>PO BOX 1121<br/>WOLFFORTH TX 79382</p> | <p>6 SLD FARMS LP<br/>2639 CR 230<br/>MEADOW TX 79345</p> <p>7 DARLA KAY &amp; CRAIG EDWARD BROOKS<br/>10513 EAST CR 109<br/>MIDLAND TX 79705</p> <p>8 AVEL ROCHA<br/>PO BOX 164<br/>MEADOW TX 79345</p> <p>9 CLETUS CASSWELL<br/>4 CATHAM CT<br/>MIDLAND, TX 79705</p> <p>10 LYNN SPURGEON &amp; LINDA BECK CARROLL<br/>315 N RENFRO ST<br/>MEADOW TX 79345</p> |
|--|--|

**NOTE:**  
 PROPERTY OWNERS LIST AND PARCEL LOCATIONS WERE OBTAINED FROM TERRY COUNTY APPRAISAL DISTRICT RECORDS.



<input type="checkbox"/> DRAFT <input checked="" type="checkbox"/> FOR INFORMATIONAL PURPOSES ONLY <input type="checkbox"/> ISSUED FOR CONSTRUCTION	PREPARED FOR <b>MEADOW LANDFILL, LLC.</b>	<b>PERMIT TRANSFER APPLICATION          ADJACENT LANDOWNERS MAP</b>		
	DATE: 04/2022 FILE: 0120-809-11 CAD: 1-ADJACENT LANDOWNERS.DWG			DRAWN BY: JBP DESIGN BY: JBP REVIEWED BY: RJS
<b>Weaver Consultants Group</b> TBPE REGISTRATION NO. F-3727		WWW.WCGRP.COM		<b>FIGURE 1</b>

**APPENDIX G**

**TCEQ-10400 FORM**



TCEQ Use Only

# TCEQ Core Data Form

For detailed instructions regarding completion of this form, please read the Core Data Form Instructions or call 512-239-5175.

## SECTION I: General Information

1. Reason for Submission (If other is checked please describe in space provided.)		
<input type="checkbox"/> New Permit, Registration or Authorization (Core Data Form should be submitted with the program application.)		
<input type="checkbox"/> Renewal (Core Data Form should be submitted with the renewal form)	<input checked="" type="checkbox"/> Other <b>Permit Transfer</b>	
2. Customer Reference Number (if issued)	Follow this link to search for CN or RN numbers in Central Registry**	3. Regulated Entity Reference Number (if issued)
CN		RN 101570976

## SECTION II: Customer Information

4. General Customer Information	5. Effective Date for Customer Information Updates (mm/dd/yyyy)	5/27/2022	
<input checked="" type="checkbox"/> New Customer <input type="checkbox"/> Update to Customer Information <input checked="" type="checkbox"/> Change in Regulated Entity Ownership <input type="checkbox"/> Change in Legal Name (Verifiable with the Texas Secretary of State or Texas Comptroller of Public Accounts)			
<b>The Customer Name submitted here may be updated automatically based on what is current and active with the Texas Secretary of State (SOS) or Texas Comptroller of Public Accounts (CPA).</b>			
6. Customer Legal Name (If an individual, print last name first: eg: Doe, John)		If new Customer, enter previous Customer below:	
Meadow Landfill, LLC		City of Meadow	
7. TX SOS/CPA Filing Number	8. TX State Tax ID (11 digits)	9. Federal Tax ID (9 digits)	10. DUNS Number (if applicable)
0804386533	32082605257		
11. Type of Customer:	<input checked="" type="checkbox"/> Corporation	<input type="checkbox"/> Individual	Partnership: <input type="checkbox"/> General <input type="checkbox"/> Limited
Government: <input type="checkbox"/> City <input type="checkbox"/> County <input type="checkbox"/> Federal <input type="checkbox"/> State <input type="checkbox"/> Other	<input type="checkbox"/> Sole Proprietorship	<input type="checkbox"/> Other:	
12. Number of Employees	13. Independently Owned and Operated?		
<input type="checkbox"/> 0-20 <input type="checkbox"/> 21-100 <input type="checkbox"/> 101-250 <input type="checkbox"/> 251-500 <input checked="" type="checkbox"/> 501 and higher	<input type="checkbox"/> Yes <input checked="" type="checkbox"/> No		
14. Customer Role (Proposed or Actual) – as it relates to the Regulated Entity listed on this form. Please check one of the following			
<input type="checkbox"/> Owner <input type="checkbox"/> Operator <input checked="" type="checkbox"/> Owner & Operator <input type="checkbox"/> Occupational Licensee <input type="checkbox"/> Responsible Party <input type="checkbox"/> Voluntary Cleanup Applicant <input type="checkbox"/> Other:			
15. Mailing Address:	1408 N. Martin Luther King Blvd.		
	City	Lubbock	State TX      ZIP 79403      ZIP + 4 3022
16. Country Mailing Information (if outside USA)		17. E-Mail Address (if applicable)	
		bdanko@republicservices.com	
18. Telephone Number	19. Extension or Code	20. Fax Number (if applicable)	
( 325 ) 716-5650		(   ) -	

## SECTION III: Regulated Entity Information

21. General Regulated Entity Information (If 'New Regulated Entity' is selected below this form should be accompanied by a permit application)		
<input type="checkbox"/> New Regulated Entity <input type="checkbox"/> Update to Regulated Entity Name <input checked="" type="checkbox"/> Update to Regulated Entity Information		
<b>The Regulated Entity Name submitted may be updated in order to meet TCEQ Agency Data Standards (removal of organizational endings such as Inc, LP, or LLC).</b>		
22. Regulated Entity Name (Enter name of the site where the regulated action is taking place.)		
City of Meadow Landfill		

23. Street Address of the Regulated Entity: <i>(No PO Boxes)</i>	663 County Road 545							
	City	Meadow	State	TX	ZIP	79345	ZIP + 4	
24. County	Terry							

Enter Physical Location Description if no street address is provided.

25. Description to Physical Location:	West side of County Road 545, approximately 1.5 miles south of FM 211								
26. Nearest City	Meadow				State	TX	Nearest ZIP Code		79345
27. Latitude (N) In Decimal:	Degrees			Minutes			Seconds		
	33	18	00	28. Longitude (W) In Decimal:			Degrees		
				102	Minutes			Seconds	
					11	18			
29. Primary SIC Code (4 digits)	4953	30. Secondary SIC Code (4 digits)		31. Primary NAICS Code (5 or 6 digits)	562212	32. Secondary NAICS Code (5 or 6 digits)			
33. What is the Primary Business of this entity? <i>(Do not repeat the SIC or NAICS description.)</i>									
Municipal Solid Waste Landfill									
34. Mailing Address:	1408 N. Martin Luther King Blvd.								
	City	Lubbock	State	TX	ZIP	79403	ZIP + 4	3022	
35. E-Mail Address:	Brian Danko (bdanko@republicservices.com)								
36. Telephone Number	( 325 ) 716-5650			37. Extension or Code		38. Fax Number <i>(if applicable)</i>			
						( ) -			

39. TCEQ Programs and ID Numbers Check all Programs and write in the permits/registration numbers that will be affected by the updates submitted on this form. See the Core Data Form instructions for additional guidance.

<input type="checkbox"/> Dam Safety	<input type="checkbox"/> Districts	<input type="checkbox"/> Edwards Aquifer	<input type="checkbox"/> Emissions Inventory Air	<input type="checkbox"/> Industrial Hazardous Waste
<input checked="" type="checkbox"/> Municipal Solid Waste	<input type="checkbox"/> New Source Review Air	<input type="checkbox"/> OSSF	<input type="checkbox"/> Petroleum Storage Tank	<input type="checkbox"/> PWS
2293				
<input type="checkbox"/> Sludge	<input type="checkbox"/> Storm Water	<input type="checkbox"/> Title V Air	<input type="checkbox"/> Tires	<input type="checkbox"/> Used Oil
<input type="checkbox"/> Voluntary Cleanup	<input type="checkbox"/> Waste Water	<input type="checkbox"/> Wastewater Agriculture	<input type="checkbox"/> Water Rights	<input type="checkbox"/> Other:

**SECTION IV: Preparer Information**

40. Name:	Ryne J. Spicer	41. Title:	Project Director
42. Telephone Number	43. Ext./Code	44. Fax Number	45. E-Mail Address
( 817 ) 735-9770		( 817 ) 735-9775	rspicer@wcgrp.com

**SECTION V: Authorized Signature**

46. By my signature below, I certify, to the best of my knowledge, that the information provided in this form is true and complete, and that I have signature authority to submit this form on behalf of the entity specified in Section II, Field 6 and/or as required for the updates to the ID numbers identified in field 39.

Company:	Meadow Landfill, LLC	Job Title:	Environmental Manager
Name (In Print):	Brian Danko	Phone:	( 325 ) 716- 5650
Signature:		Date:	MAY 2, 2022

**APPENDIX H**  
**TCEQ-20650 FORM**

Facility Name: City of Meadow Landfill  
Permittee/Registrant Name: Meadow Landfill, LLC  
MSW Authorization #: 2293  
Initial Submittal Date: 04/2022  
Revision Date:



## Texas Commission on Environmental Quality

### Permit/Registration Modification and Temporary Authorization Application Form for an MSW Facility

#### 1. Reason for Submittal

- Initial Submittal                       Notice of Deficiency (NOD) Response

#### 2. Authorization Type

- Permit     Registration

#### 3. Application Type

- Modification with Public Notice                       Modification without Public Notice  
 Temporary Authorization (TA)                       Modification for Name Change/Transfer

#### 4. Application Fees

- Pay by Check     Online Payment

If paid online, enter ePay Trace Number: **582EA000457143**

#### 5. Application URL

Is the application submitted for a permit/registration modification with public notice?

- Yes     No

If the answer is "Yes", enter the URL address of a publicly accessible internet web site where the application and all revisions to that application will be posted in the space provided: <http://ftwweaverboos.com>

#### 6. Confidential Documents

Does the application contain confidential documents?

- Yes     No

If "Yes", cross-reference the confidential documents throughout the application and submit as a separate attachment in a binder clearly marked "CONFIDENTIAL."



Facility Name: **City of Meadow Landfill**  
MSW Authorization #: **2293**

Initial Submittal Date: **04/2022**  
Revision Date:

**7. General Facility Information**

Facility Name: **City of Meadow Landfill**  
MSW Authorization No.: **2293**  
Regulated Entity Reference No.: **RN101570976**  
Physical or Street Address (if available): **663 County Road 545**  
City: **Meadow** County: **Terry** State: **TX** Zip Code: **79345**  
(Area code) Telephone Number: **806-539-2377**  
Latitude: **33° 18' 00"** Longitude: **102° 11' 18"**

**8. Facility Type(s)**

Type I                       Type IV                       Type V  
 Type I AE                       Type IV AE                       Type VI

**9. Description of the Revisions to the Facility**

Provide a brief description of all revisions to the permit/registration conditions and supporting documents referred by the permit/registration, and a reference to the specific provisions under which the modification/temporary authorization application is being made. Also, provide an explanation of why the modification/temporary authorization is requested: **The purpose of this application is to transfer MSW Permit No. 2293 from the City of Meadow to Meadow Landfill, LLC.**

This section is intentionally left blank; please continue to the next page.

**10. Facility Contact Information**

**Site Operator (Permittee/Registrant) Name: Meadow Landfill, LLC**

Customer Reference No. (if issued)\*: CN

Mailing Address: **1408 N. Martin Luther King Blvd.**

City: **Lubbock** County: **Terry** State: **TX** Zip Code: **79403**

(Area Code) Telephone Number: **325-716-5650**

**Email Address: Brian Danko (bdanko@republicservices.com)**

TX Secretary of State (SOS) Filing Number: **0804386533**

\*If the Site Operator (Permittee/Registrant) does not have this number, complete a TCEQ Core Data Form (TCEQ-10400) and submit it with this application. List the Site Operator (Permittee/Registrant) as the Customer.

**Operator Name<sup>1</sup>: Same as Site Operator**

Customer Reference No. (if issued)\*:

Mailing Address:

City: County: State: Zip Code:

(Area Code) Telephone Number:

Email Address:

Charter Number:

<sup>1</sup>If the Operator is the same as Site Operator/Permittee type "Same as "Site Operator (Permittee/Registrant)".

\*If the Operator does not have this number, complete a TCEQ Core Data Form (TCEQ-10400) and submit it with this application. List the Operator as the customer.

**Consultant Name (if applicable): Weaver Consultants Group, LLC**

Texas Board of Professional Engineers Firm Registration Number: **F-3727**

Mailing Address: **6420 Southwest Boulevard, Suite 206**

City: **Fort Worth** County: **Tarrant** State: **Texas** Zip Code: **76109**

(Area Code) Telephone Number: **817-735-9770**

Email Address: **Ryne Spicer (rspicer@wcgrp.com)**

**Agent in Service Name (required only for out-of-state):**

Mailing Address:

City: County: State: Zip Code:

(Area Code) Telephone Number:

Email Address:

**11. Ownership Status of the Facility**

Is this a modification that changes the legal description, the property owner, or the Site Operator (Permittee/Registrant)?

Yes                       No

If the answer is "No", skip this section.

Does the Site Operator (Permittee/Registrant) own all the facility units and all the facility property?

Yes                       No

If "No", provide the information requested below for any additional ownership.

**Owner Name: City of Meadow**

Street or P.O. Box: **906 1<sup>st</sup> St.**

City: **Meadow** County: **Terry** State: **Texas** Zip Code: **79345-3136**

(Area Code) Telephone Number: **806-539-2377**

Email Address: **cityofmeadow@yahoo.com**

Charter Number:

Facility Name: **City of Meadow Landfill**  
MSW Authorization #: **2293**

Initial Submittal Date: **04/2022**  
Revision Date:

### Signature Page

I, Brian Danko, Environmental Manager,  
(Site Operator (Permittee/Registrant)'s Authorized Signatory) (Title)

certify under penalty of law that this document and all attachments were prepared under my direction or supervision in accordance with a system designed to assure that qualified personnel properly gather and evaluate the information submitted. Based on my inquiry of the person or persons who manage the system, or those persons directly responsible for gathering the information, the information submitted is, to the best of my knowledge and belief, true, accurate, and complete. I am aware there are significant penalties for submitting false information, including the possibility of fine and imprisonment for knowing violations.

Signature: *Brian Danko*

Date: May 2, 2022

-----  
TO BE COMPLETED BY THE OPERATOR IF THE APPLICATION IS SIGNED BY AN AUTHORIZED REPRESENTATIVE FOR THE OPERATOR

I, \_\_\_\_\_, hereby designate \_\_\_\_\_  
(Print or Type Operator Name) (Print or Type Representative Name)

as my representative and hereby authorize said representative to sign any application, submit additional information as may be requested by the Commission; and/or appear for me at any hearing or before the Texas Commission on Environmental Quality in conjunction with this request for a Texas Water Code or Texas Solid Waste Disposal Act permit. I further understand that I am responsible for the contents of this application, for oral statements given by my authorized representative in support of the application, and for compliance with the terms and conditions of any permit which might be issued based upon this application.

\_\_\_\_\_  
Printed or Typed Name of Operator or Principal Executive Officer

\_\_\_\_\_  
Signature

-----  
SUBSCRIBED AND SWORN to before me by the said Brian Danko

On this 2nd day of May 2022

My commission expires on the 17th day of May 2025

Helen M Hanson  
Notary Public in and for

Tarrant County, Texas

(Note: Application Must Bear Signature & Seal of Notary Public)

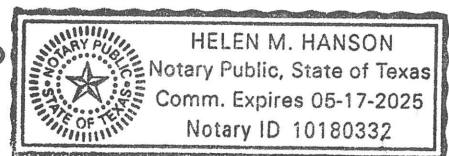

Facility Name: **City of Meadow Landfill**  
MSW Authorization #: **2293**

Initial Submittal Date: **04/2022**  
Revision Date:

## **Permit/Registration Modification with Public Notice**

(See Instructions for P.E. seal requirements.)

### **Required Attachments**

### **Attachment No.**

Land Ownership Map

Land Ownership List

Marked (Redline/Strikeout) Pages

Unmarked Revised Pages

### **Additional Attachments as Applicable- Select all those apply and add as necessary**

- Signatory Authority
- Fee Payment Receipt
- Confidential Documents

Facility Name: **City of Meadow Landfill**  
MSW Authorization #: **2293**

Initial Submittal Date: **04/2022**  
Revision Date:

## **Permit/Registration Modification without Public Notice or TA**

(See Instructions for P.E. seal requirements.)

### **Required Attachments (for Modifications only)**

**Attachment No.**

Marked (Redline/Strikeout) Pages

Unmarked Revised Pages

### **Additional Attachments as Applicable- Select all those apply and add as necessary**

- Signatory Authority
- Fee Payment Receipt
- Confidential Documents

Facility Name: **City of Meadow Landfill**  
MSW Authorization #: **2293**

Initial Submittal Date: **04/2022**  
Revision Date:

## Permit/Registration Name Change/Transfer Modification

(See Instructions for P.E. seal requirements.)

### Required Attachments

TCEQ Core Data Form(s)

Property Legal Description

    Property Metes and Bounds Description

    Metes and Bounds Drawings

    On-Site Easements Drawing

Land Ownership List

Land Ownership Map

Property Owner Affidavit

Verification of Legal Status

Evidence of Competency

### Attachment No.

**Appendix G**

**Appendix B-1**

**Appendix B-1**

**Appendix B-1**

**Appendix B-2**

**Appendix F**

**Appendix F**

**Appendix B**

**Appendix D**

**Appendix E**

### Additional Attachments as Applicable- Select all those apply and add as necessary

- Signatory Authority
- Fee Payment Receipt
- Confidential Documents
- Final Plat Record of Property, if platted
- Assumed Name Certificate

**APPENDIX I**

**APPLICANT CERTIFICATION**



## APPLICANT CERTIFICATION

---

I certify under penalty of law that this document and all attachments were prepared under my direction or supervision in accordance with a system designed to assure that qualified personnel properly gathered and evaluated the information submitted. Based on my inquiry of the person or persons who manage the system, or those persons directly responsible for gathering the information, the information is, to the best of knowledge and belief, true, accurate, and complete. I am aware that there are significant penalties for submitting false information, including the possibility of fine and imprisonment for knowing violations.

This will also advise you that I have duly appointed Weaver Consultants Group, LLC, as consulting and design engineers for the purpose of preparing and submitting the attached Permit Transfer Application.

Authorized Representative: Brian Danko  
Title: Environmental Manager  
Meadow Landfill, LLC

Signature:  Date: May 2, 2022

Brian Danko  
Environmental Manager  
Republic Waste Services of Texas, Ltd.  
1408 N. Martin Luther King Blvd.  
Lubbock, Texas 79403-3022  
325-716-5650